

# PARTS LIST

| Ref# | Description                                     | Part#  | QTY    |
|------|---|--------|--------|
| 1    | 36" Double Door Locker                          | 47433  | 1 pc   |
| 2    | Hexagon bolt with flange screw (M6X25)          |        | 12 pcs |
| 3    | 26" Cabinet frame                               | 47280  | 1 pc   |
| 4    | 26" Cupboard                                    | 47276  | 2 pcs  |
| 5    | Pipe ( 30X30mm )                                | 47284  | 2 pcs  |
| 6    | Truss head screw ( M6X12, stainless )           |        | 16 pcs |
| 7    | 26" Hanger board                                | 47376  | 2 pcs  |
| 8    | HEX socket head cap screw with washer ( M6X16 ) |        | 8 pcs  |
| 9    | Pipe ( 60X30mm )                                | 47283  | 1 pc   |
| 10   | HEX socket head cap screw ( M8X20 )             |        | 12 pcs |
| 11   | 26" Recycle Bin                                 | 47450  | 1 pc   |
| 12   | M6x16 Hex flange bolt                           | 321006 | 4 pcs  |
| 13   | M6 Hex Nylon locknut                            | 323112 | 4 pcs  |
| 14   | 26" Skirting side board                         | 47389  | 1 pc   |
| 15   | 26" Skirting board                              | 47289  | 2 pcs  |
| 16   | 52" SS work plate                               | 47447  | 1 pc   |
| 17   | 24" Skirting side board                         | 47310  | 1 pc   |
| 18   | 36" Skirting board                              | 47437  | 1 pc   |

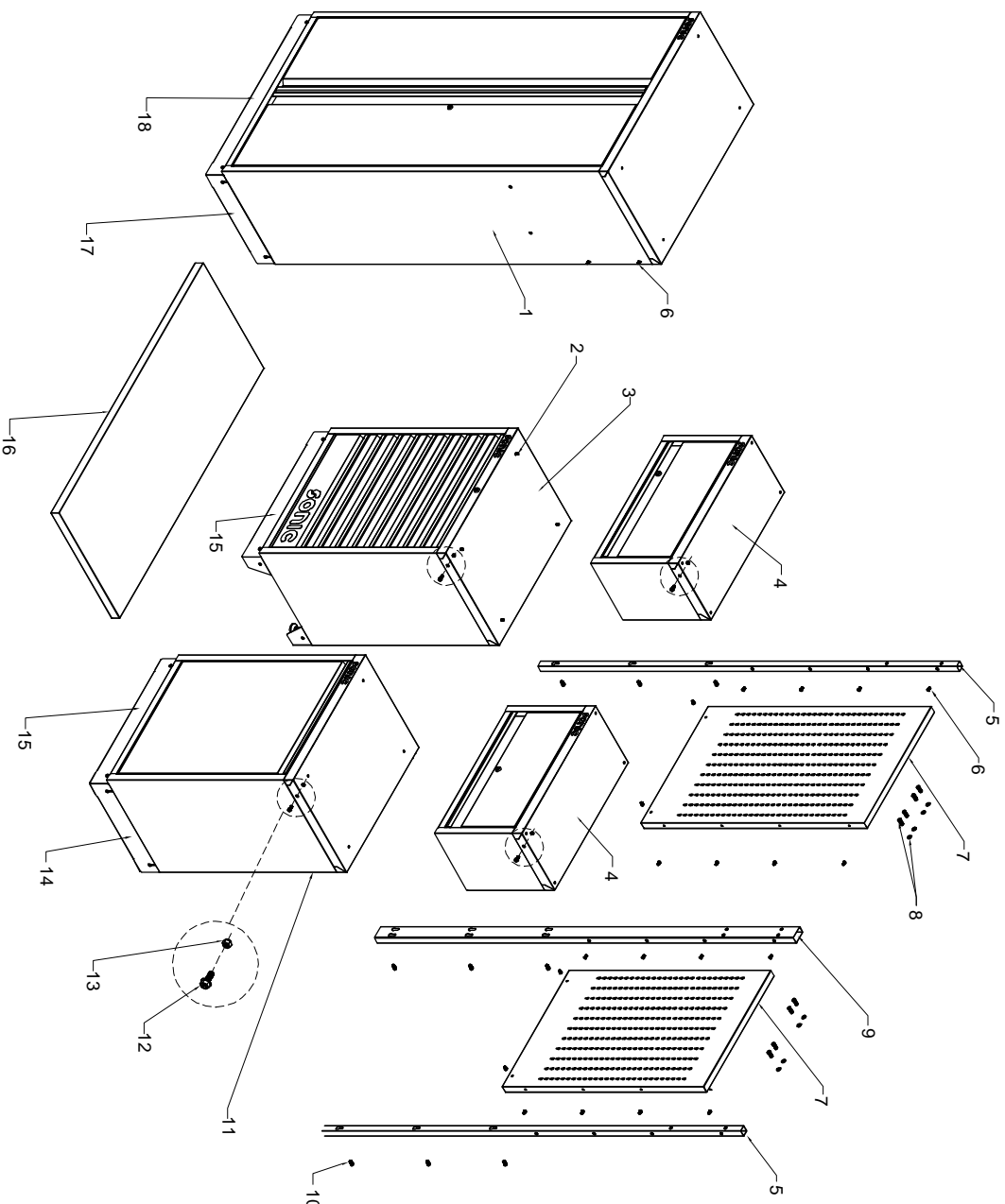

**ASSEMBLY INSTRUCTIONS**

**1. INSTALL PIPES**

Simply position the pipes over the holes on the cabinets and attach with the bolts provided. Tighten HEX socket head cap screws( **M8X20** ) securely.

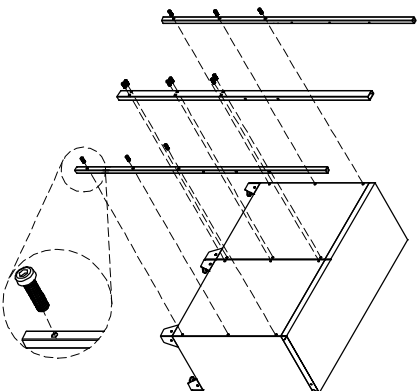

**2. INSTALL HANGER BOARD**

Simply position the hanger board over the holes and attach with the bolts provided. Tighten truss head screws( **M6X12, stainless** ) securely.

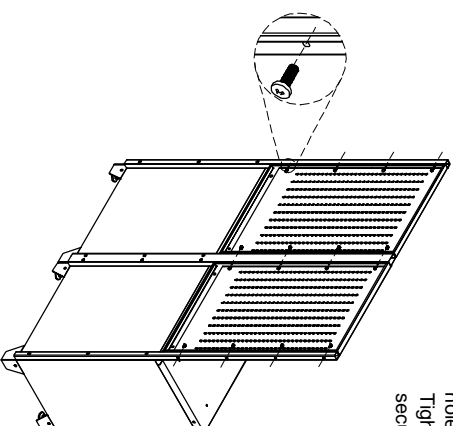

**3. ADJUST LEVELER**

Adjust the levelers and make the whole unit to stable state.

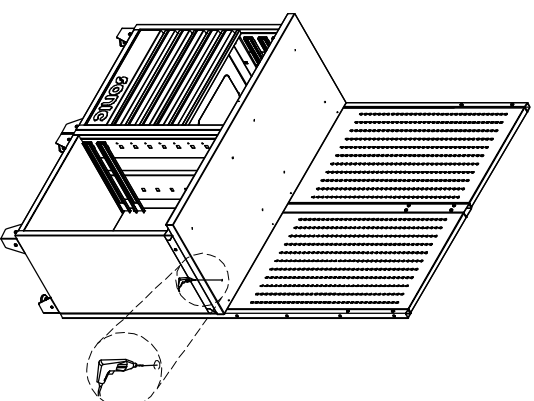
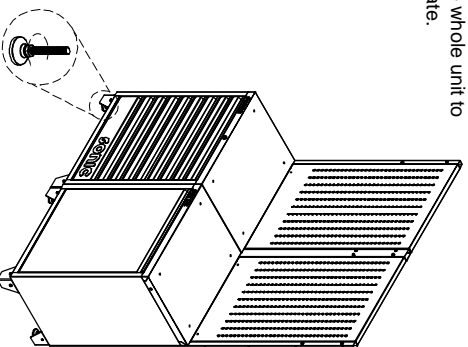

**4. PRE-DRILL HOLES OF SS WORK PLATE**

Pre-drill eight small holes under the SS work plate for easily installing. Repeat the steps for the back of SS work plate(only four holes).

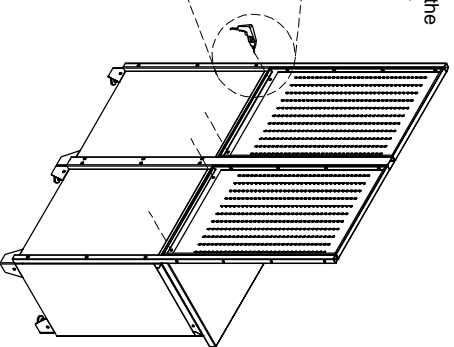
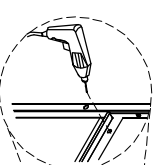

**ASSEMBLY INSTRUCTIONS**

**5. INSTALL SS WORK PLATE**

Position the SS work plate on the top of cabinets. Remove the top drawer of cabinet. Insert the Hexagon bolt with flange screw(M6X25) through the top of cabinet, and into the bottom of the SS worktop. Tighten securely. Reinstall the drawers.

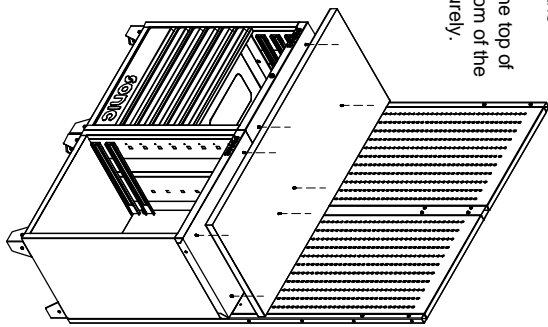

**6. INSTALL CUPBOARD**

Hang the cupboards onto the screws and attach with the HEX socket head cap screws( M6X16) provided. Tighten securely.

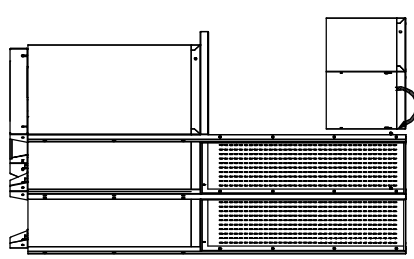

**7. INSTALL FOUR ADJUSTABLE SHELVES**

Decide the height of the adjustable shelf onto the tongues on both side panels. Insert the bolts into the side panels. Place the shelf on the bolts. Make sure slot B go to locker first. The top one is fixed, and the others are adjustable.

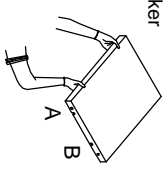

**8. INSTALL LOCKER**

Insert the truss head screws(M6X12) through the pipe(30X30mm). Tighten securely.

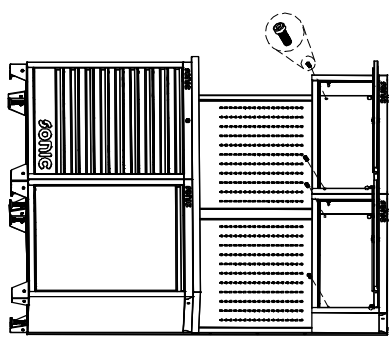
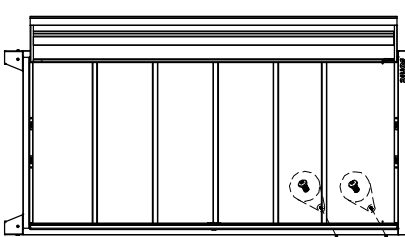

## 9. INSTALL SKIRTING BOARDS

Position the skirting boards on the legs of cabinets. Insert the truss head screw ( **M6x12, stainless** ) through the legs. Tighten securely. Repeat the steps for other skirting boards.

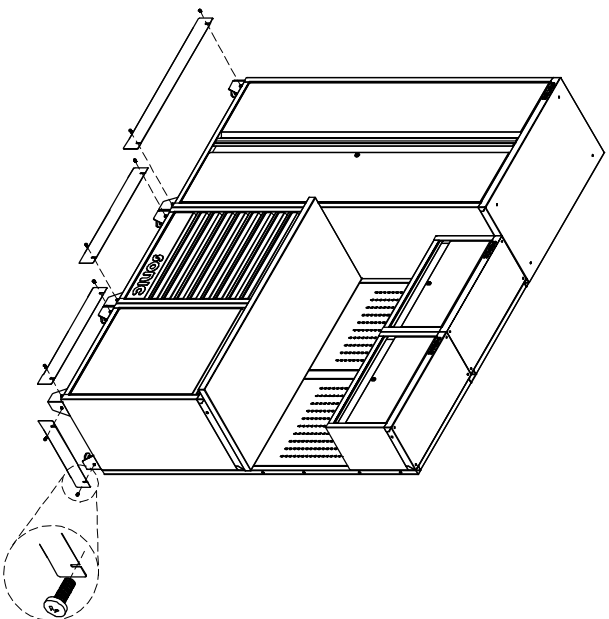

## 10. CONNECT THE CABINETS, CONNECT THE CUPBOARDS

Remove the top drawer of cabinet. Insert M6x16 Hex flange bolts with M6 Hex Nylon locknuts between two cabinets. Insert M6x16 Hex flange bolts with M6 Hex Nylon locknuts between two cupboards.

