

Applications

Make	Model	Year
Dacia	Dokker	2012-2014
	Lodgy	2012-2014
	Logan	2004-2013
	Logan MCV	2006-2013
	Logan Pick-up	2008-2013
	Logan Van/Express	2006-2013
	Sandero	2008-2013

Engine Code	
1.4	K7J 710, K7J 714
1.6	K7M 710, K7M 718, K7M 732, K7M 800, K7M 812, K7M 818

Our products are designed to be used correctly and with care for the purpose for which they are intended. No liability is accepted by Sonic for incorrect use of any of our products, and Sonic cannot be held responsible for any damage to personnel, property or equipment when using the tools. Incorrect use will also invalidate the warranty.

If applicable, the applications database and any instructional information provided has been designed to offer general guidance for a particular tool's use and while all attention is given to the accuracy of the data no project should be attempted without referring first to the manufacturer's technical documentation (workshop or instruction manual) or the use of a recognised authority such as Autodata.

It is our policy to continually improve our products and thus we reserve the right to alter specifications and components without prior notice. It is the responsibility of the user to ensure the suitability of the tools and information prior to their use.



Instructions

Engine Timing Kit
Renault/Dacia Petrol (K7J/K7M) -
1.4, 1.6



829057 - Engine Timing Kit

Description:

The 829057 has been specifically put together to allow the user to lock the engine components of the 1.4 and 1.6 Renault engines used across the Dacia range.

The 829057 kit includes the belt pre-tensioner lever required on engines equipped with a manual tensioner.

Components

Ref	Comp	OEM	Description
1	4880048	MOT 1489	Crankshaft Timing Pin
2	4880102	MOT 1145-01	Tensioner Adjusting Tool
3	4880295	MOT 1501	Pretensioner Tool

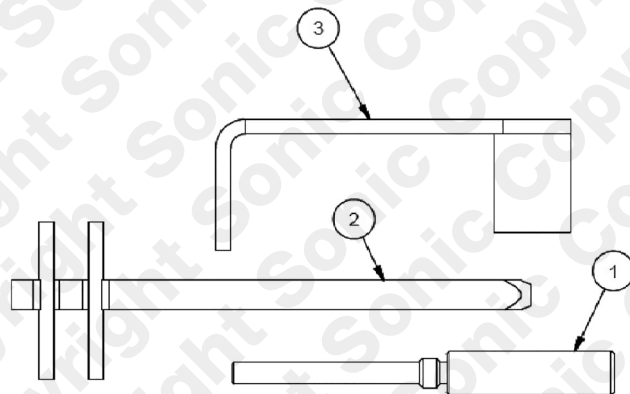

Instructions

The following instructions are for guidance only. Please refer to OEM derived data such as the vehicles manufactures own data or Autodata. The use of these engine timing tools is purely down to the user's discretion and Sonic cannot be held responsible for any damage caused what so ever.

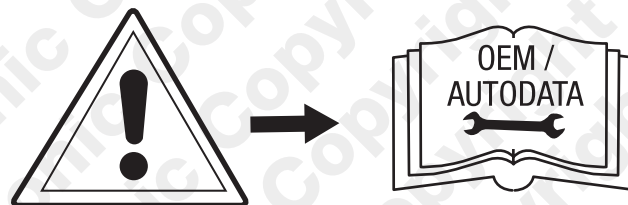

Crankshaft Locking PIN (1)

- Align the crankshaft timing mark just before the 6 o'clock position and fit timing pin as shown
- Turn the crank till it stops against the pin. The timing mark should be now in the 6 o'clock position as shown.

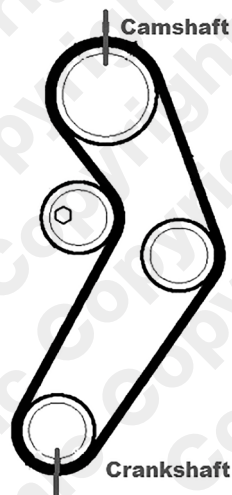
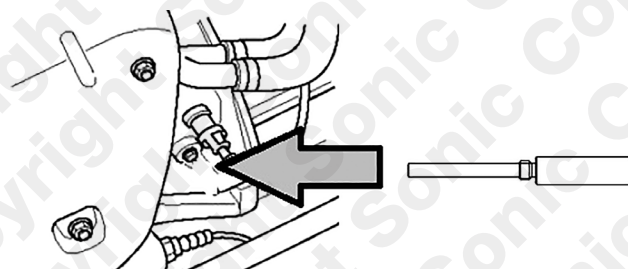

Component 2/3: Tensioner Adjusting Tool & pre-tensioner
Components 2 and 3 are used together with a suitable tension gauge to load the belt and set the tensioner.

**Always consult the vehicle manufacturers torque data when using these tools.