

Applications

Make	Model	Year
Fiat	Croma	2005-2009
Vauxhall/Opel	VX220/Speedster	2000-2006
	Zafira-A	2000-2005
	Astra-G	2000-2006
	Vectra-B	2000-2002
	Vectra-C	2002-2008
	Signum	2003-2008
	Vectra-C	2003-2008
	Zafira-B/Zafira Family	2005-2012
	Astra-H	2006-2011

Engine Code

2.2 19A1.000, Z22SE, Z22YH

Our products are designed to be used correctly and with care for the purpose for which they are intended. No liability is accepted by Sonic for incorrect use of any of our products, and Sonic cannot be held responsible for any damage to personnel, property or equipment when using the tools. Incorrect use will also invalidate the warranty.

If applicable, the applications database and any instructional information provided has been designed to offer general guidance for a particular tool's use and while all attention is given to the accuracy of the data no project should be attempted without referring first to the manufacturer's technical documentation (workshop or instruction manual) or the use of a recognised authority such as Autodata.

It is our policy to continually improve our products and thus we reserve the right to alter specifications and components without prior notice. It is the responsibility of the user to ensure the suitability of the tools and information prior to their use.



Instructions

Twin Camshaft Locking Tool
Opel, Fiat Petrol - 2.2



829022 - Twin Camshaft Locking Tool

Description:

The 829022 consists of 2 components, the camshaft locking tool and tensioner pin required to align the engine components of the Opel/ Fiat/Renault 2.2 twin cam 16v petrol engine.

Components

Ref	Comp	OEM	Description
1	4880179	KM 6148	Camshaft Locking Tool (Assembled)
2	4880180	KM 6077	Tension Pin 1.0mm

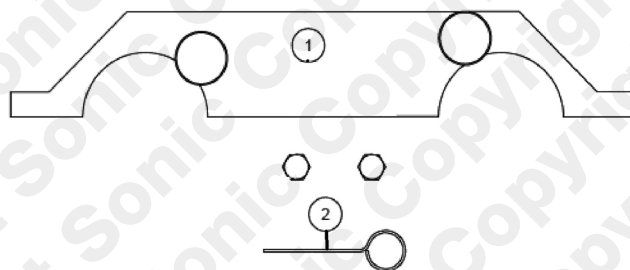

Instructions

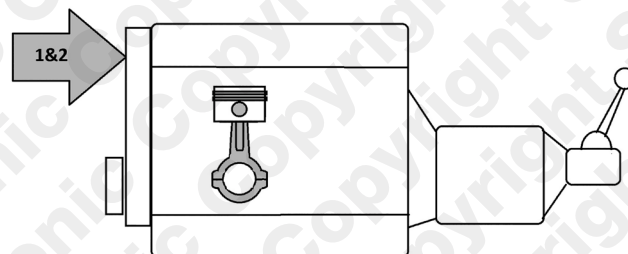

- Align all timing marks and coloured chain links as described by OEM instructions

Component 1 - Camshaft Locking tool

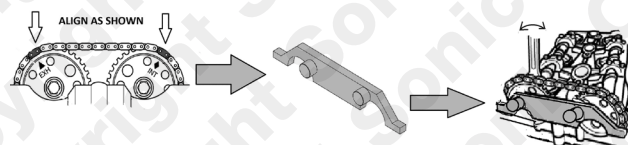

Instructions

The following instructions are for guidance only. Please refer to OEM derived data such as the vehicles manufactures own data or Autodata. The use of these engine timing tools is purely down to the user's discretion and Sonic cannot be held responsible for any damage caused what so ever.

