

Applications

Make	Model	Type	Range	Year
BMW	1 Series	(E81/82/87/88) (F20/21)	116d	2007-
			118d	
			120d	
			120d/xDrive	
			123d	
	3 Series	(E90/91/92/93) (F30/31)	316d	
			318d	
			320d	
			320d/xDrive	
			325d	
			325d	
			330d	
			330d/xDrive	
			335d/xDrive	
			518d	
	5 Series	(E60/61) (F10/11) (F07)	520d	
			520d GT	
			520d/xDrive	
			525d/xDrive	
			530d	
			530d GT	
			530d/xDrive	
			535d	
			535d/xDrive	
			535d/xDrive GT	
	X1/X3	(E84) (E83) (F25)	sDrive16d	
			sDrive18d	
			sDrive20d	
			xDrive 20d	
			xDrive18d	
			xDrive20d	
			xDrive23d	
			xDrive25d	
			xDrive30d	
			xDrive35d	
	6 Series	(F12/13) (F06)	640d/xDrive	
			640d	
	7 Series	(F01/02/04)	730d	
			730d/xDrive	
			740d/xDrive	
	X5	(E70)	xDrive 30d	
	X6	(E71/72)	xDrive 40d	

Engine Code	
1.6D	N47 D16, N47 D16C
2.0D	N47, N47 D20A, N47 D20A/0U0, N47 D20A/K0, N47 D20A/00, N47 D20C, N47 D20C/01, N47 D20C/K1, N47 D20C/0, N47 D20C/01, N47 D20C/U1, N47 D20D, N47 D20D/T1, N47 D2000, N47 D2001, N47 D20U0, N47S D20B/D/T0, N47S D20D/T0, N47T D2001, N47T D20U1
3.0D	N57 D30, N57 D30A, N57 D30A/00, N57 D30A/01, N57 D30A/00, N57 D30B, N57 D30B/T0, N57 D30B/T1, N57 D3000, N57 D3001, N57 D30T0, N57 D30T0, N57 D30U0, N57 D30U0, N57 D30C, N57 D30C/S1

Our products are designed to be used correctly and with care for the purpose for which they are intended. No liability is accepted by Sonic for incorrect use of any of our products, and Sonic cannot be held responsible for any damage to personnel, property or equipment when using the tools. Incorrect use will also invalidate the warranty.

If applicable, the applications database and any instructional information provided has been designed to offer general guidance for a particular tool's use and while all attention is given to the accuracy of the data no project should be attempted without referring first to the manufacturer's technical documentation (workshop or instruction manual) or the use of a recognised authority such as Autodata.

It is our policy to continually improve our products and thus we reserve the right to alter specifications and components without prior notice. It is the responsibility of the user to ensure the suitability of the tools and information prior to their use.

ART NO. 829102

sonic
equipment

Instructions

Crankshaft Holding Tool BMW Diesel N47/57 - 1,6/2,0/3,0



829102 - Crankshaft Holding Tool

Description:

829102 is a crankshaft locking and holding tool is designed to lock the crankshaft on the N47 (2.0L) and N57 (3.0L) diesel engines from 2007 found in the BMW range. It is specifically required when replacing or repairing the secondary drive chains on the engines listed.

Additional Camshaft or Balance shaft tooling may be required
Equivalent to OEM 11 4 320.

Components

Ref	Comp	OEM	Description
1		11 4 320	Crankshaft setting tool (plate) N47/N57
2			Pin
3			M5 Countersunk Screw
4			M6 Bolt
5			Washer
6			M6 Nut

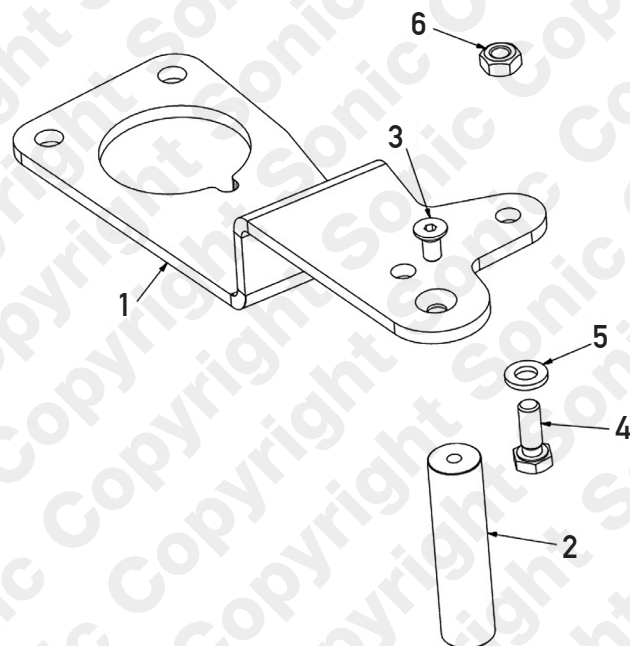

Instructions

The following instructions are for guidance only. Please refer to OEM derived data such as the vehicles manufactures own data or Autodata.
The use of these engine timing tools is purely down to the user's discretion and Sonic cannot be held responsible for any damage caused what so ever.

