

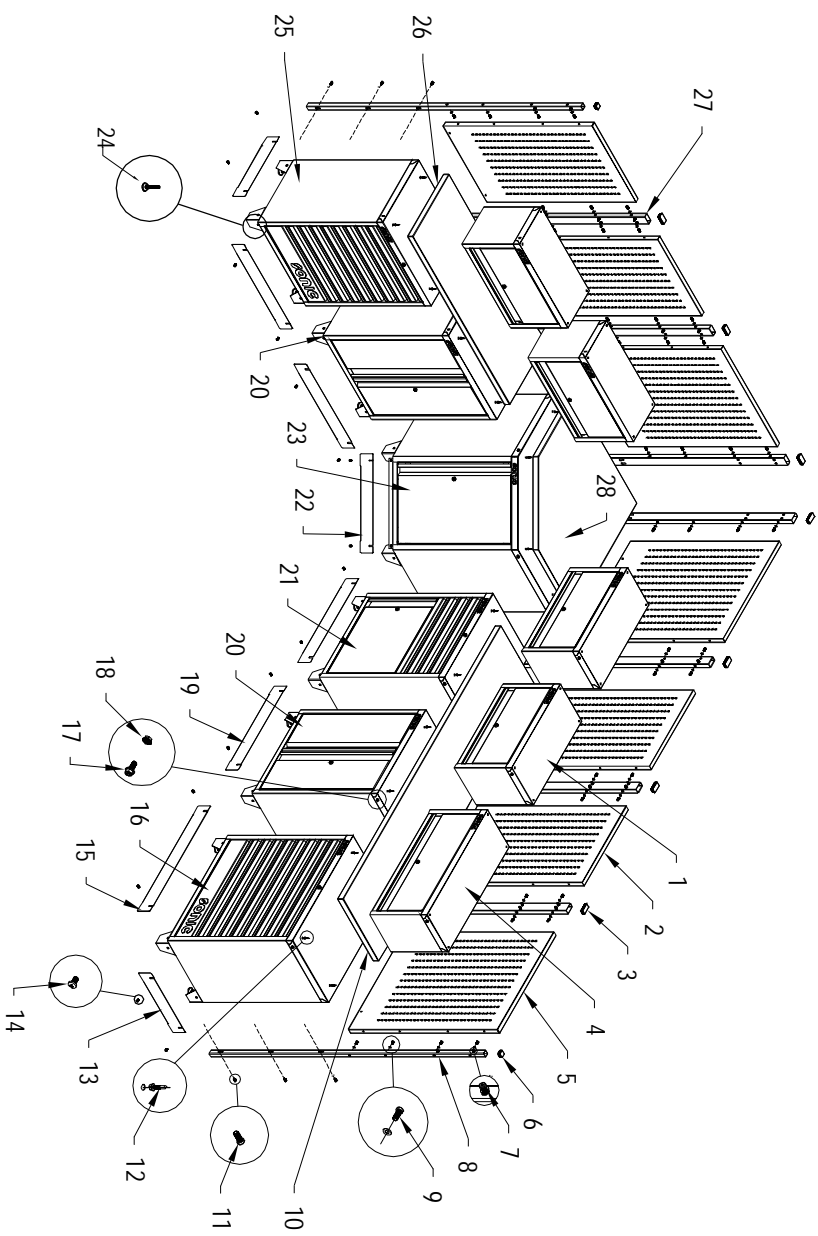

PARTS LIST

Ref#	Description	Part#	QTY
1	26" Cupboard	47276	4 pcs
2	26" Hanger board	47376	4 pcs
3	End Cap	314010	7 pcs
4	34" Cupboard	47292	1 pc
5	34" Hanger board	47380	3 pcs
6	End Cap	314009	2 pcs
7	HEX socket head cap screw (M6X16) with washer	320111	20 sets
8	Pipe (30X30mm)	47284	2 pcs
9	Phillipps Head Bolt((M6x12) with washer	320023	56 sets
10	86" Wooden work plate	47306	1 pc
11	HEX socket head cap screw (M8X20)	320113	45 pcs
12	Hexagon bolt with flange screw (M4.8X25)	320122	27 pcs
13	26" & 34" closet side board	47389	2 pcs
14	Phillipps Head Bolt((M6x12)	320023	16 pcs
15	34" Skirting board	47303	1 pc
16	34" Cabinet frame	47296	1 pc
17	Hex Flange Bolt((M6x16)	321006	8 pcs
18	Hex Flange Nut	323085	8 pcs
19	26" Skirting board	47289	4 pcs
20	26" Closet frame	47288	2 pcs
21	26" frame of Cabinet with door	47308	1 pc
22	Front Skirting board	47541	1 pc
23	34" Corner frame	47505	1 pc
24	Adjustable Feet	313004	25 pcs
25	26" Cabinet frame	47280	1 pc
26	52" Wooden work plate	47279	1 pc
27	Pipe (60X30mm)	47283	7 pcs
28	34" Corner wooden work plate	47544	1 pc





1. READY&INSTALL PIPES

A) Arrange the cabinets.

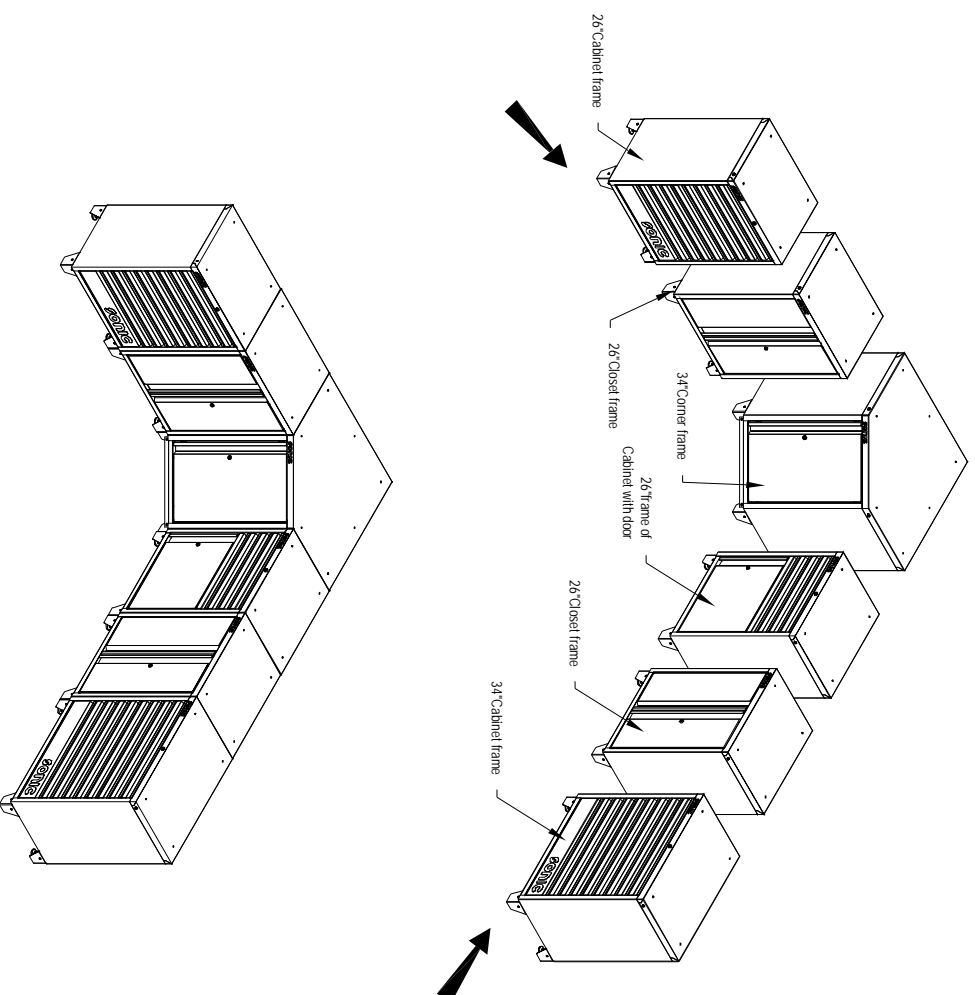

B) Simply position the pipes over the holes on the cabinets and attach with the bolts provided. Tighten HEX socket head cap screws (**M8X20**) securely.

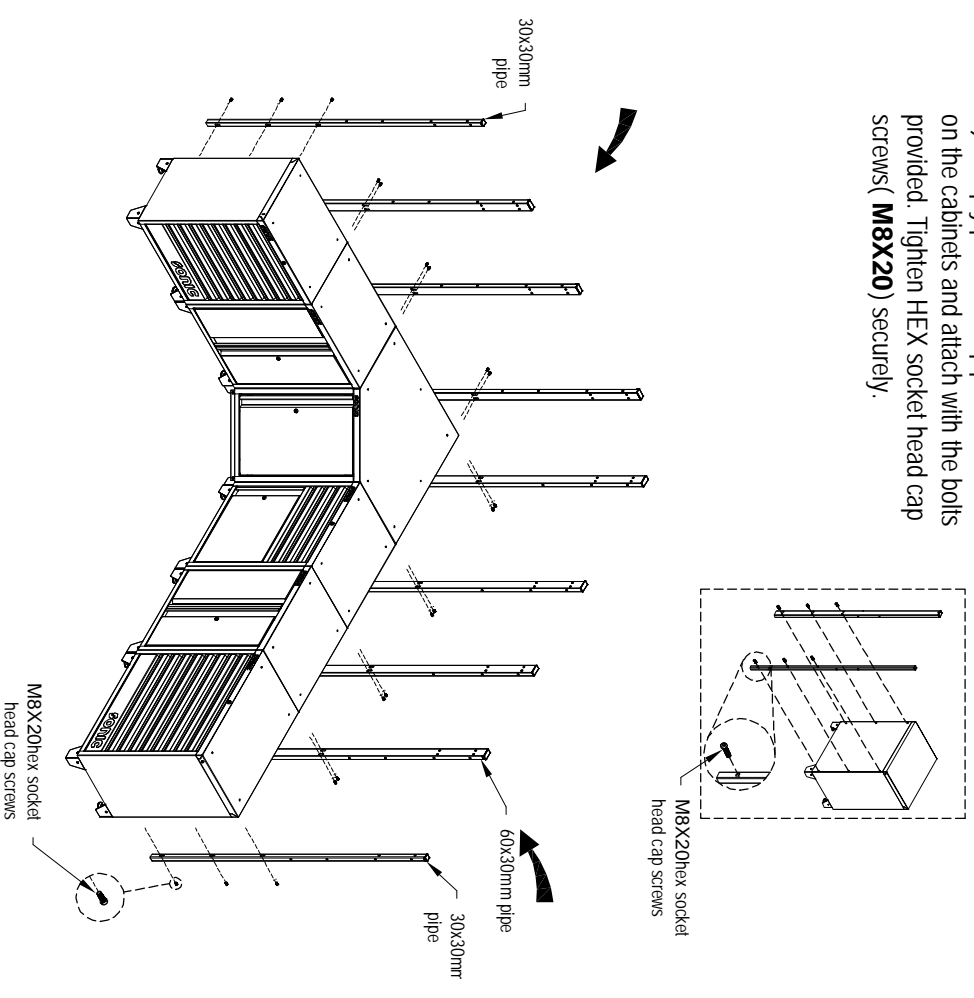



ASSEMBLY INSTRUCTIONS

2. INSTALL HANGER BOARD

Simply position the hanger board over the holes and attach with the bolts provided.
Tighten philipps head bolt (**M6X12, stainless**) securely.

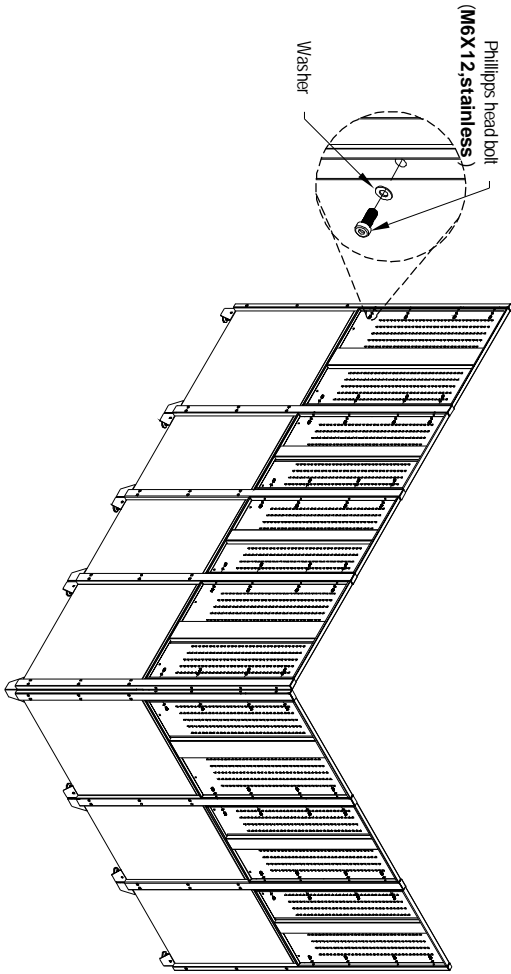
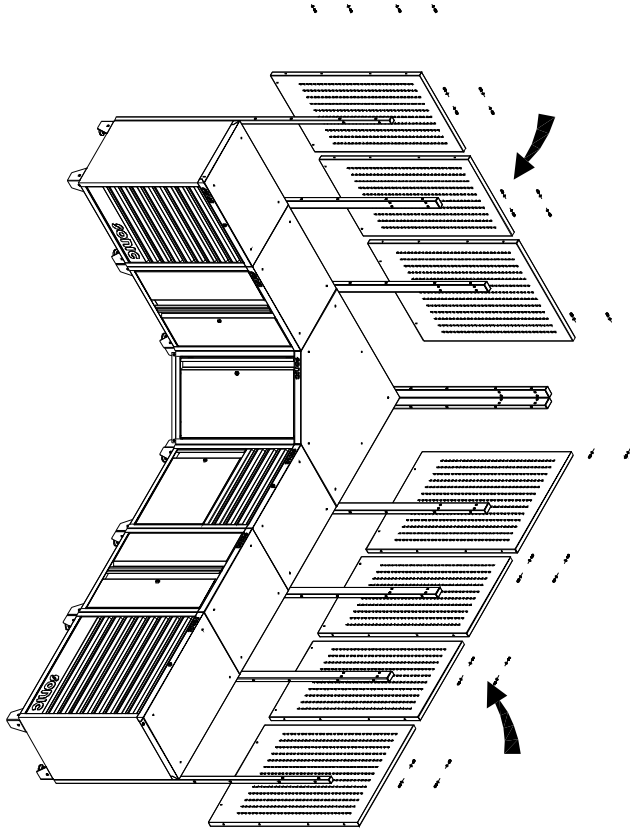

3. ADJUST THE LEVEL AND CONNECT EACH CABINET

A) Remove the drawers, shelves and doors.
Adjust the adjustable feet to make the whole set-up in a same level.

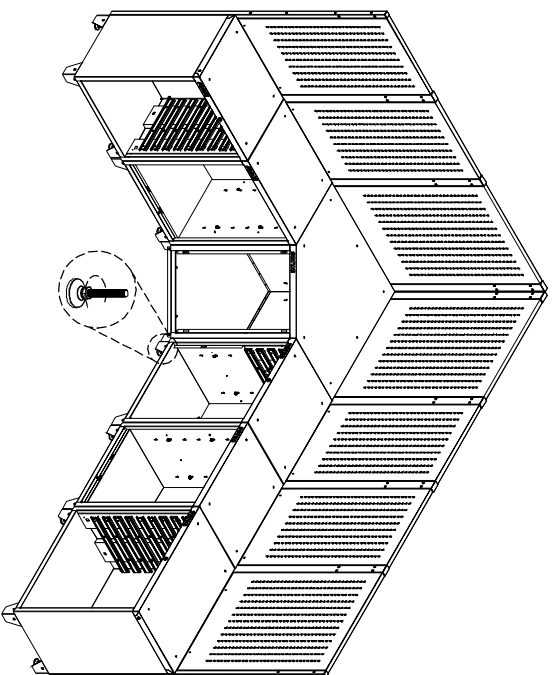

B) To connect each cabinet by hex flange bolt (M6x16) and hex flange nut. Tighten the screws securely.

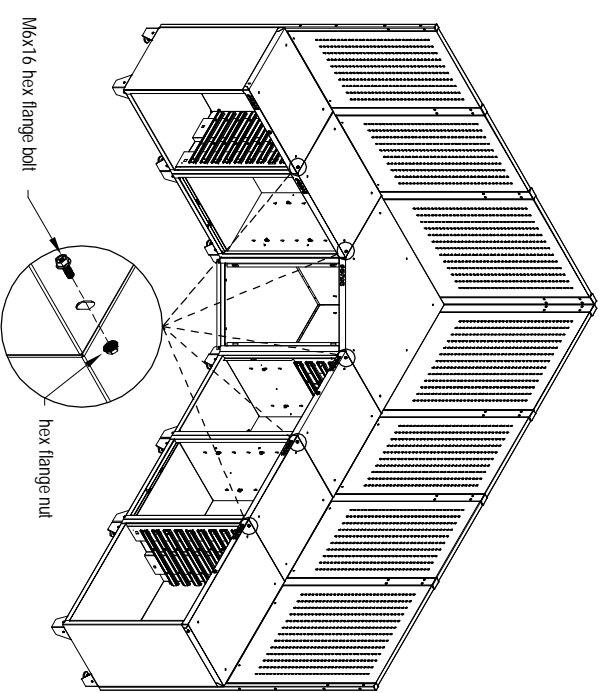

ASSEMBLY INSTRUCTIONS

4. INSTALL CUPBOARD

A) Hang the cupboards onto the screws and attach with the HEX socket head cap screws (**M6X16**) and washers provided. Do not tighten them yet. Make some space to hang up the wall chest. Open the chest and put 2 more screws (**M6X16**) and washers to connect with the post. Tighten the screws securely.

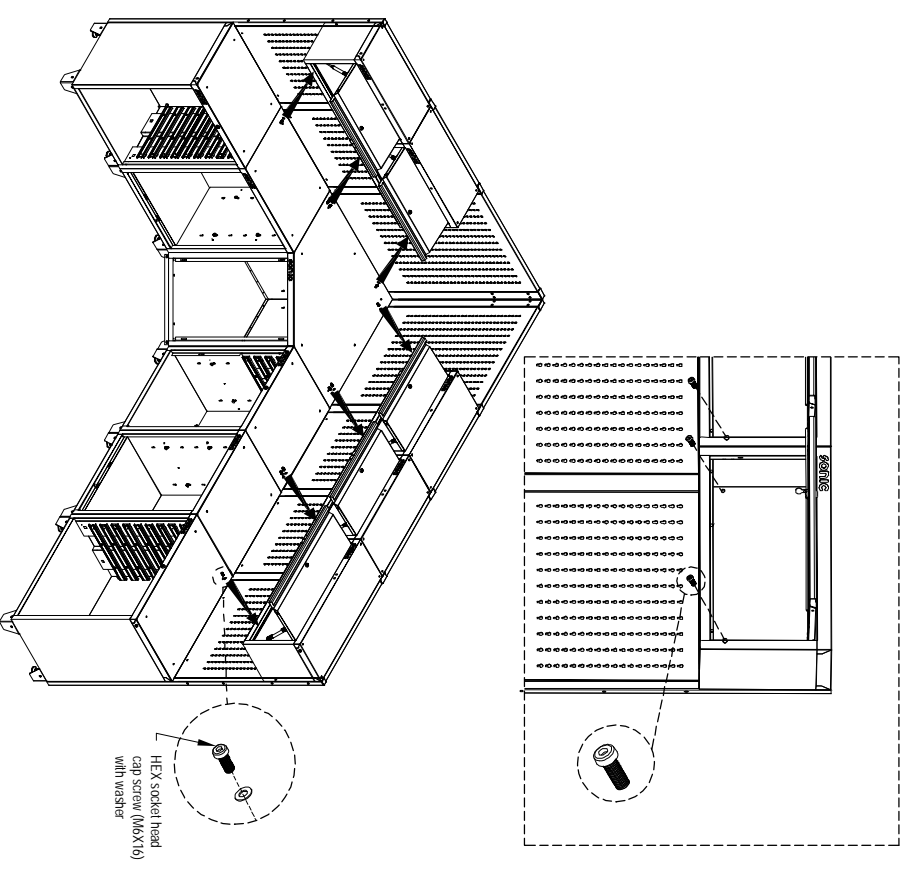
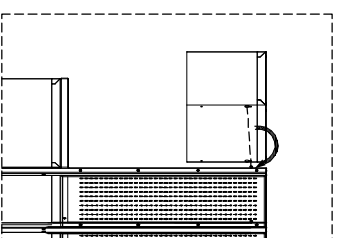
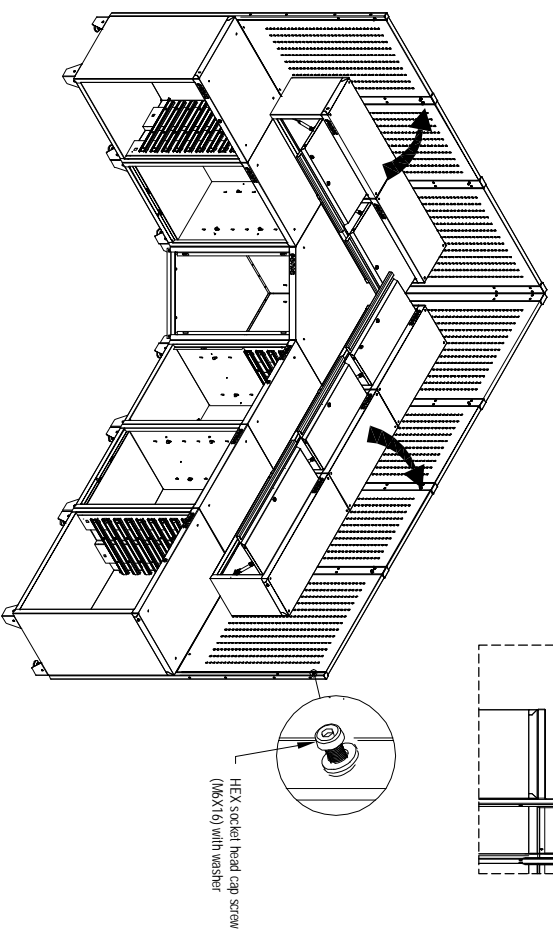



B) After hanging up the wall chest, connect the two chests together by hex flange bolt(M6x16) and nuts. Adjust their height to make sure they are in the same level.

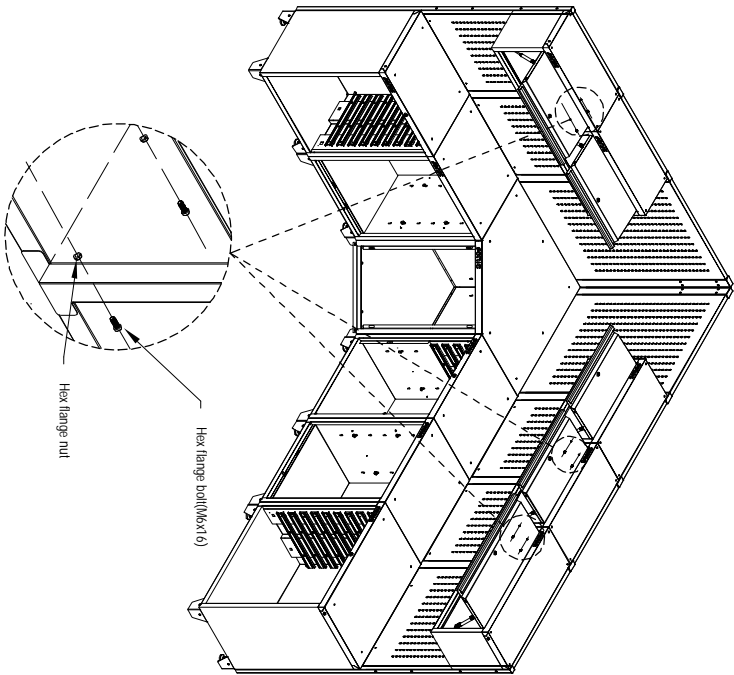

5. INSTALL THE WOODEN WORK PLATE

A) Put the wooden work plates on the cabinet.

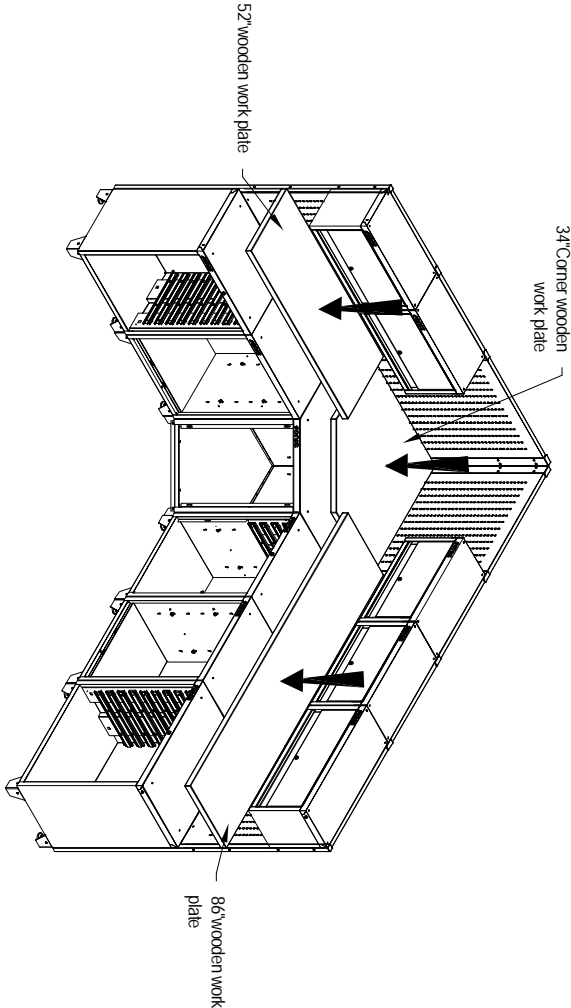

ASSEMBLY INSTRUCTIONS

6. INTALL SKIRTING BOARDS

Position the skirting boards on the legs of cabinets.
Insert the philipps head bolt (**M6X12,stainless**)
through the legs. Tighten securely. Repeat the steps
for other skirting boards.

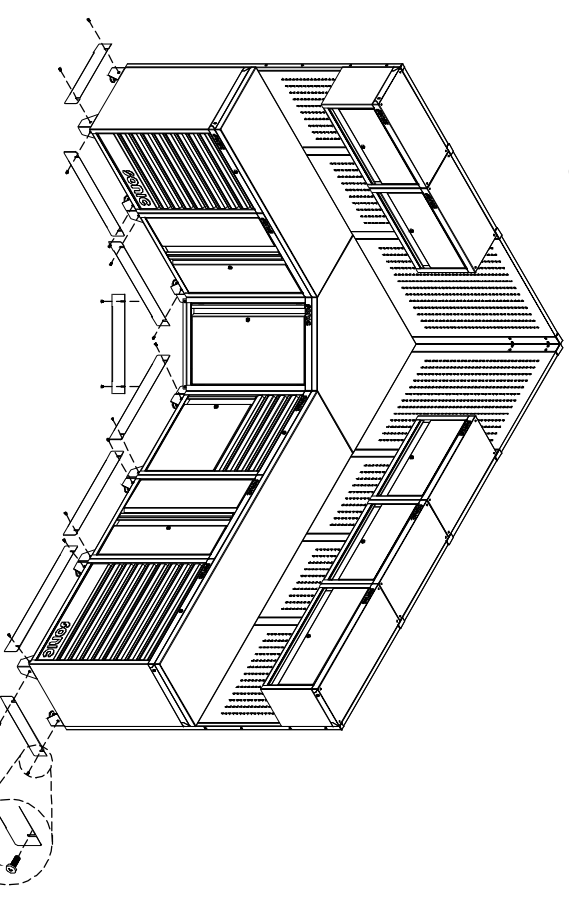

B)Position the wooden work plate on the top of cabinets.
Screw the hexagon bolt with flange screws (**M4.8X25**) through
the top of cabinet by electric driver into the bottom of the
wooden worktop. Tighten securely.
Reinstall the drawers, shelves and doors.

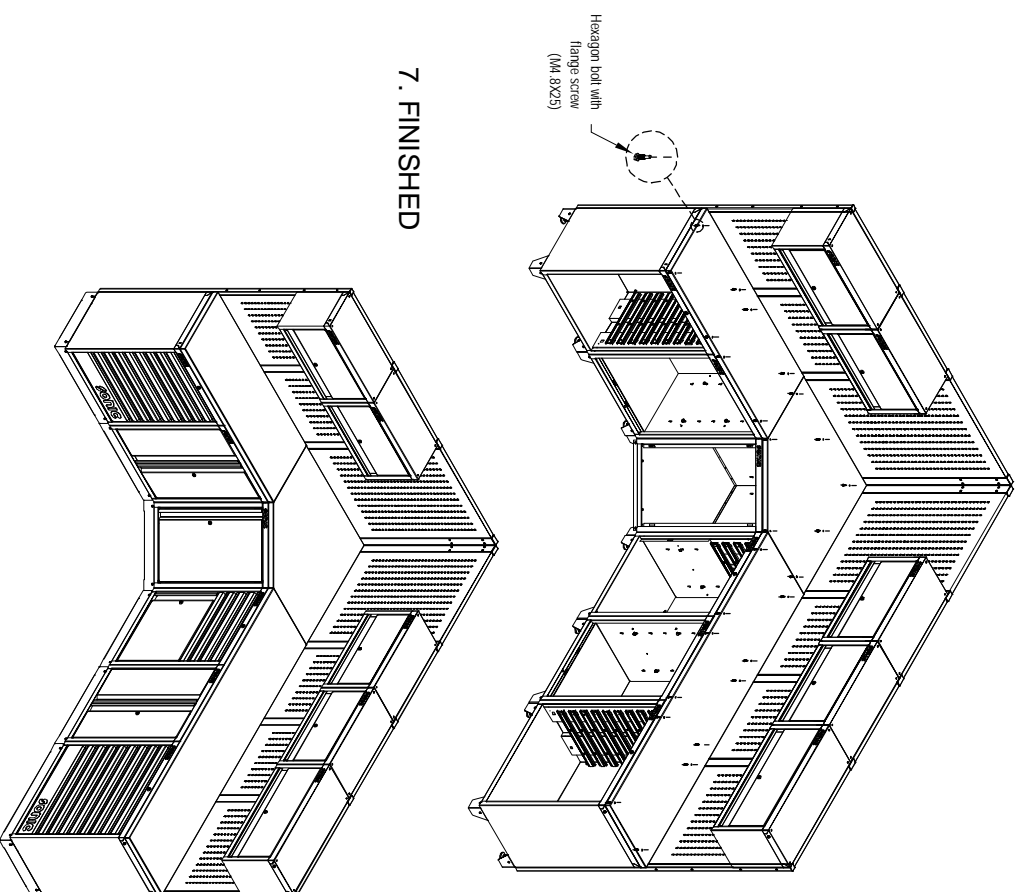

7. FINISHED

