

Applications

Make	Model	Year	Types
Alfa Romeo	MiTo	2011-2015	TwinAir Turbo TwinAir TwinAir Turbo Natural Power TwinAir Turbo Natural Power CNG
Chrysler	Ypsilon	2011-2015	
Fiat	500	2010-2016	
	Panda	2012-2016	
	Punto	2012-2014	
Lancia	Ypsilon	2011-2016	

Engine Code	
0.9	312A2.000

Our products are designed to be used correctly and with care for the purpose for which they are intended. No liability is accepted by Sonic for incorrect use of any of our products, and Sonic cannot be held responsible for any damage to personnel, property or equipment when using the tools. Incorrect use will also invalidate the warranty.

If applicable, the applications database and any instructional information provided has been designed to offer general guidance for a particular tool's use and while all attention is given to the accuracy of the data no project should be attempted without referring first to the manufacturer's technical documentation (workshop or instruction manual) or the use of a recognised authority such as Autodata.

It is our policy to continually improve our products and thus we reserve the right to alter specifications and components without prior notice. It is the responsibility of the user to ensure the suitability of the tools and information prior to their use.



Instructions

Engine Timing Kit
Fiat TwinAir Petrol - 0.9



829021 - Engine Timing Kit

Description:

The 829021 has been developed for the Twin Air Turbo 0.9L Fiat petrol engine found in Fiat, Alfa Romeo and Lancia vehicles.

Components

Ref	Comp	OEM	Description
1	4880266	2 000 035 100	Fiat/Alfa Twinair Camshaft Locking Tool
2	4880265	2 000 035 200	Timing Pin - Straight - Pulley Alignment
3	4880264	2 000 035 300	Timing Pin - Bent - Flywheel Locking Pin
4			M8 x 25mm Socket Head Cap Screw

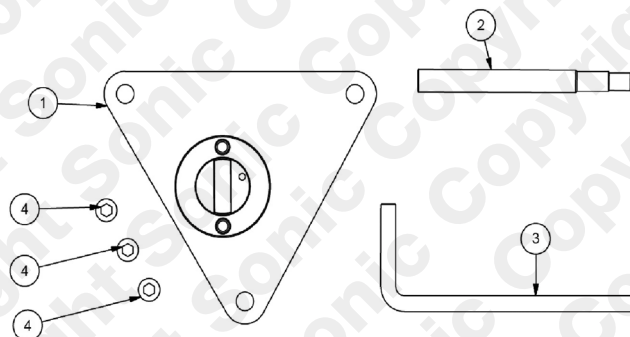

Instructions

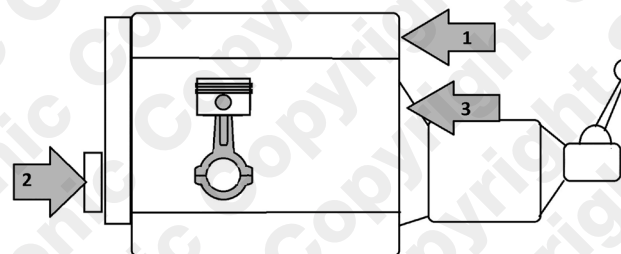

- Align all timing marks as described by OEM instructions with cylinder number 1 at TDC.

Component 1 - Camshaft Locking tool

Component 1 bolts on to the cylinder head at the gearbox end of the engine to lock the end of the camshaft in it timed position.

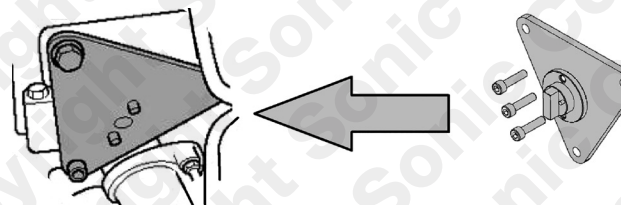

Component 2 - Crankshaft Front Pulley Alignment Pin

Component 2 is used to lock the crankshaft front pulley in its timed position.

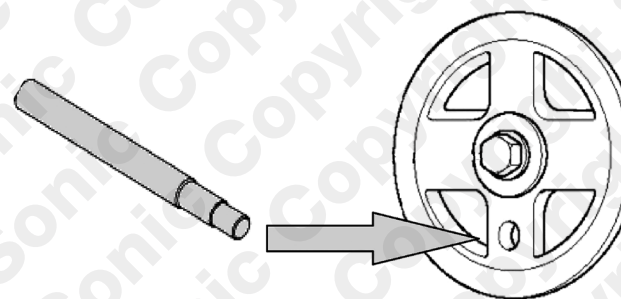

Component 3 - Timing Pin - Bent - Flywheel Locking Pin

Component 3 is used to lock the crankshaft in it timed position via the flywheel. Fit 3 through the timing hole in the top of the gearbox bell housing as shown.

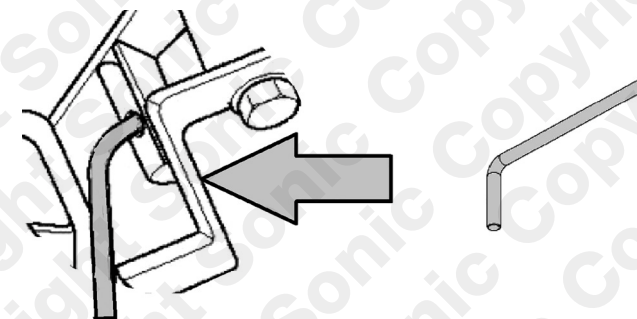

Instructions

The following instructions are for guidance only. Please refer to OEM derived data such as the vehicles manufactures own data or Autodata. The use of these engine timing tools is purely down to the user's discretion and Sonic cannot be held responsible for any damage caused what so ever.

