

Slide hammer puller set

Slide hammer puller sets have several pulling attachments to give the user various methods for pulling, maintenance, and repair applications.

- Pulls flange-type rear axles and most front-wheel drive hubs.
- Internal and external jaws provide a variety of combinations to pull bearings, gears and seals.
- Two and three-way cross blocks and cone provide the perfect jaw configuration for most jobs.
- Grip wrench adaptor and dent puller for sheet metal or other unique pulling requirements.
- Hammer in polished chrome finish.



Parts List

- | | |
|-----------------------------------|------------------------|
| 1. Front hub puller head | 8. Bolt & nut |
| 2. Cone block | 9. Forcing screw |
| 3. Puller head for 3 jaw | 10. Retainer |
| 4. Internal / External puller jaw | 11. Seal hook |
| 5. Rear axle puller head | 12. Hex nut |
| 6. Grip wrench adaptor | 13. Self tapping screw |
| 7. Puller head for 2 jaw | 14. Slide hammer |

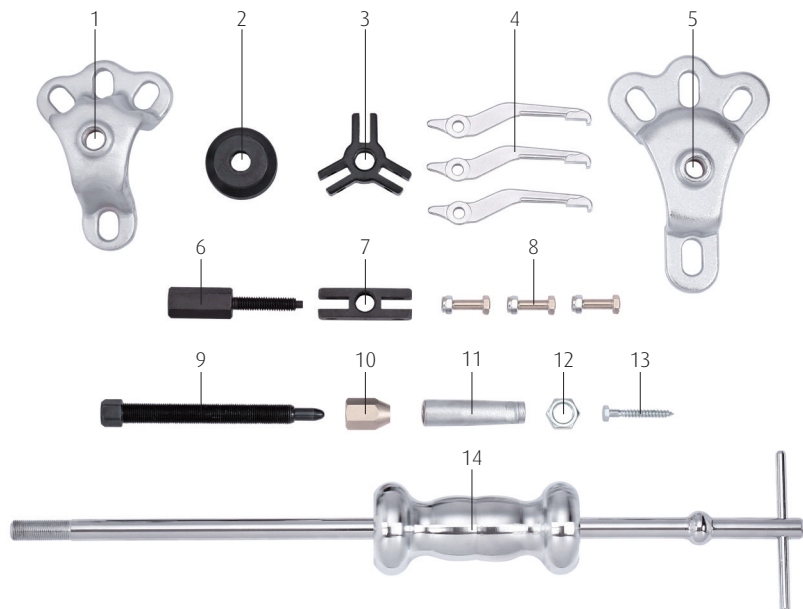

WWW.SONIC-EQUIPMENT.COM

CAUTION

- Adjusting strap bolts must be tight on puller jaws.
- Puller legs and jaws must be in-line and the setup must be rigid.
- Apply force gradually. If maximum force has been applied and the work piece has not moved, use a puller with a larger capacity. Do NOT hit the part with a hammer in an attempt to jar it loose.

Assemblies

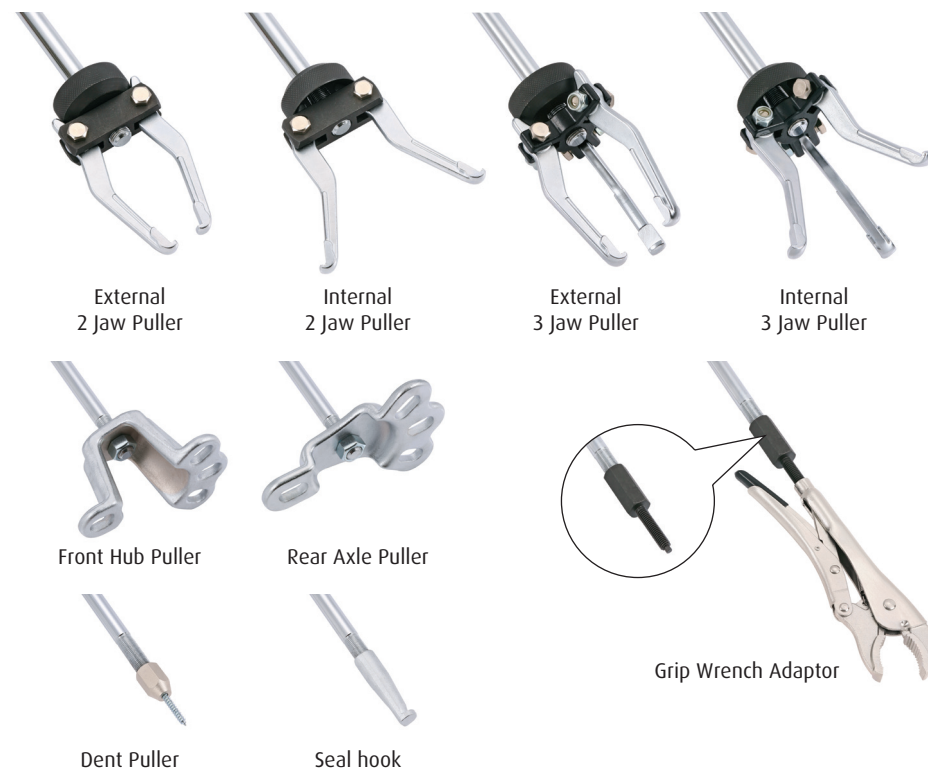

*Important:

When using the jaws in the spread or reversed position, thread the cone block as close to the puller head as possible to ensure a firm grip on the part.

