

Applications

Make	Model	Year	Type
Fiat	Ducato	2002-2012	JTD MultiJet 120
Iveco	Daily	2004-2006	MultiJet 130 29/35 HPI

Engine Code	
2.3	F1AE0481C, F1AE0481D, F1AE0481N

Our products are designed to be used correctly and with care for the purpose for which they are intended. No liability is accepted by Sonic for incorrect use of any of our products, and Sonic cannot be held responsible for any damage to personnel, property or equipment when using the tools. Incorrect use will also invalidate the warranty.

If applicable, the applications database and any instructional information provided has been designed to offer general guidance for a particular tool's use and while all attention is given to the accuracy of the data no project should be attempted without referring first to the manufacturer's technical documentation (workshop or instruction manual) or the use of a recognised authority such as Autodata.

It is our policy to continually improve our products and thus we reserve the right to alter specifications and components without prior notice. It is the responsibility of the user to ensure the suitability of the tools and information prior to their use.



Instructions

Engine Timing Kit
Fiat JTD Diesel - 2.3, 3.0



829025 - Engine Timing Kit

Description:

The 829025 is an engine timing locking tool set for Fiat Ducato 2.3 JTD. This kit includes the latest Crankshaft Timing Pin required on engines produced from 2006-2008. The 2.3 JTD twin camshaft Common Rail diesel engines are belt driven between crankshaft and inlet camshaft but utilise a chain to connect both camshafts.

Components

Ref	Comp	OEM	Description
1	4880130	99360614	Camshaft Alignment Pins x2
2	4880131	99360615	Crankshaft Alignment Tool
3	4880090	1 860 617 000	5mm x 50 Camshaft Alignment Pin
4	4880001	2 000 018 200	Crankshaft Shaft Locking Screw

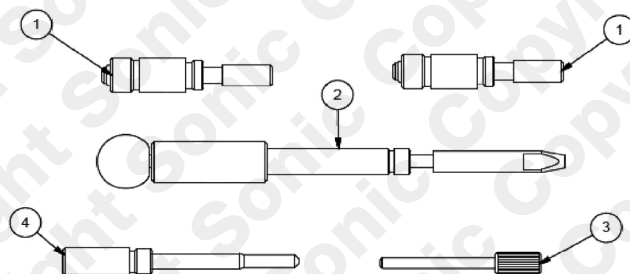

Instructions

The following instructions are for guidance only. Please refer to OEM derived data such as the vehicles manufactures own data or Autodata. The use of these engine timing tools is purely down to the user's discretion and Sonic cannot be held responsible for any damage caused what so ever.

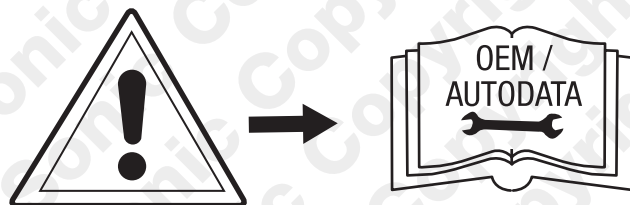

Instructions

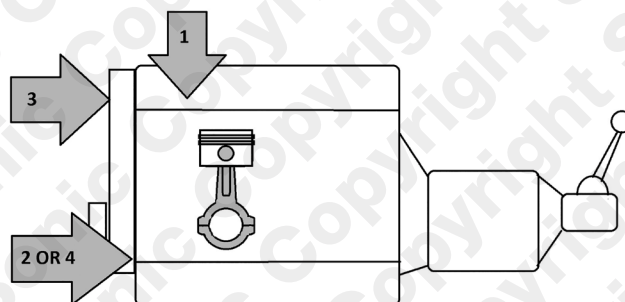

Component 1 - Camshaft Alignment Pins
Used to align the camshafts in their timed position.

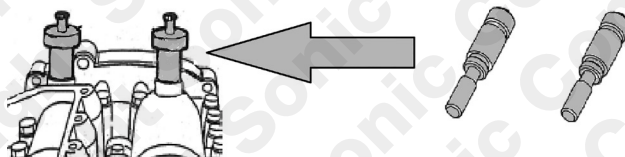

Component 2 & 4 - Crankshaft Locking Pins
Components 2 & 4 are used to lock the crankshaft with the crankshaft at TDC number 1 cylinder. Component 4 is specific to post 2006 engines.

NB: do not tighten or loosen fixings against component 1.

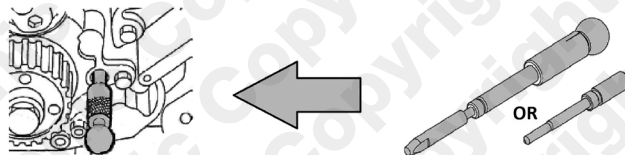

Component 3 - Camshaft Pulley Setting Pin
Component 3 is used to align the camshaft belt pulley.

