

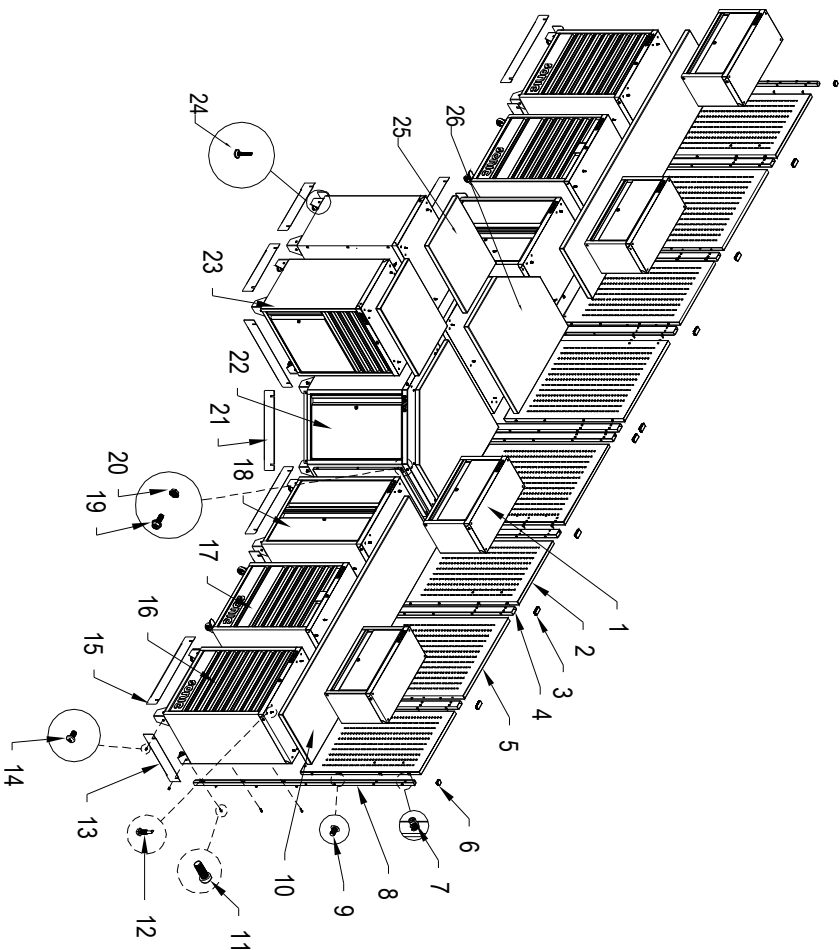

PARTS LIST

Ref#	Description	Part#	QTY
1	MSS 674mm cupboard	47276	4 pcs
2	MSS full height peg board 674x998mm	47376	4 pcs
3	End Cap	314010	7 pcs
4	MSS wire pipe 60X30mm	47283	8 pcs
5	MSS full height peg board 845x998mm	47380	4 pcs
6	End Cap	314009	2 pcs
7	HEX socket head cap screw (M6X16) with washer	320111	16 sets
8	MSS wire pipe 30X30mm	47284	2 pcs
9	Phillips Head Bolt(M6x12)	320023	64 pcs
10	MSS wooden top blade 2193x500x40mm	47306	2 pcs
11	HEX socket head cap screw (M8X20)	320113	36 pcs
12	Hexagon bolt with flange screw (M4.8X25)	320122	38 pcs
13	26"834" closet side board	47389	4 pcs
14	Phillips Head Bolt(M6x12)	320023	24 pcs
15	26"Skirting board	47289	6 pcs
16	MSS 674mm cabinet without top blade	47280	2 pcs
17	MSS 674mm toolbox 7 drawers	47451	2 pcs
18	MSS 674mm closet without top blade	47288	2 pcs
19	Hex Flange Bolt(M6x16)	321006	4 pcs
20	Hex Flange Nut	323085	4 pcs
21	Front Skirting board	47541	2 pcs
22	MSS 845mm corner closet without top blade	47505	2 pcs
23	MSS 674mm cabinet with door without top blade	47308	2 pcs
24	Adjustable Feet	313004	34pcs
25	MSS 26"wood worktop 674x500x40mm	47378	2 pcs
26	Wooden top of 47505 MSS 34" Corner closet	47544	2 pcs



1. READY& INSTALL PIPES

A) Arrange the cabinets.

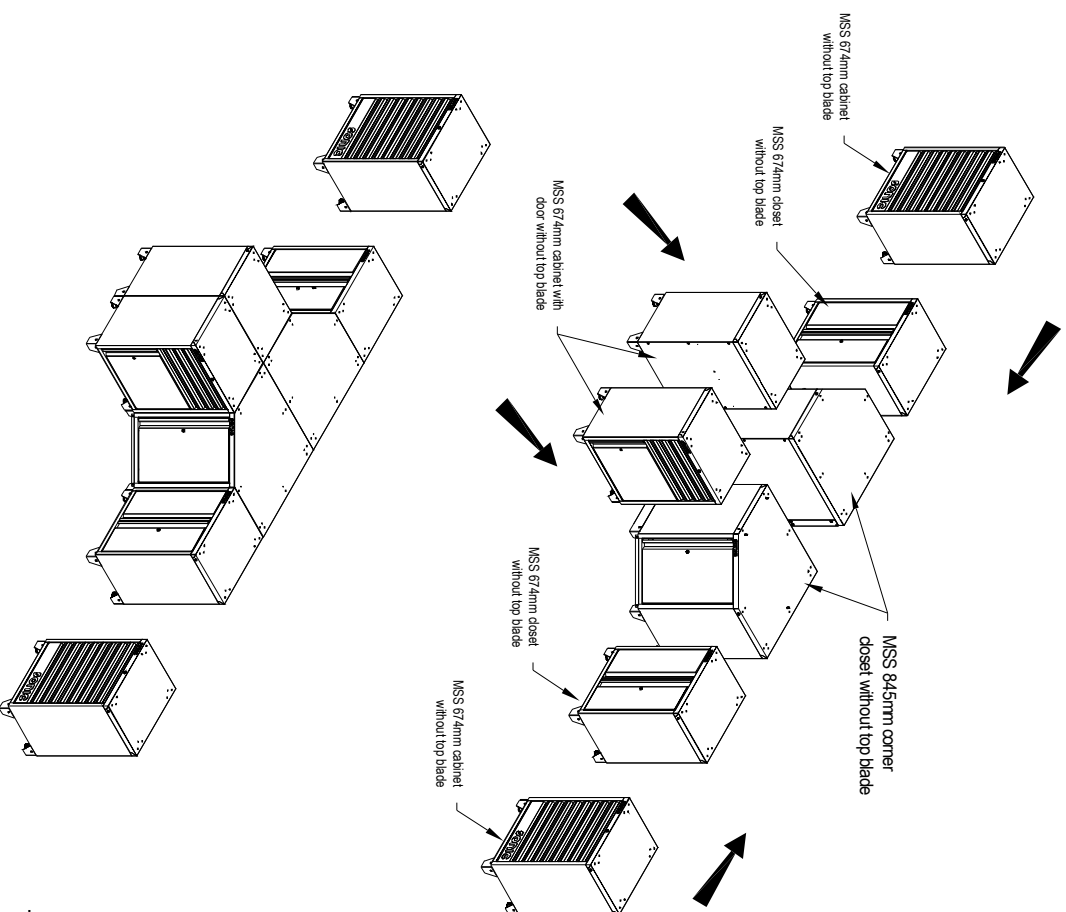

B) Simply position the pipes over the holes on the cabinets and attach with the bolts provided. Tighten HEX socket head cap screws (**M8X20**) securely.

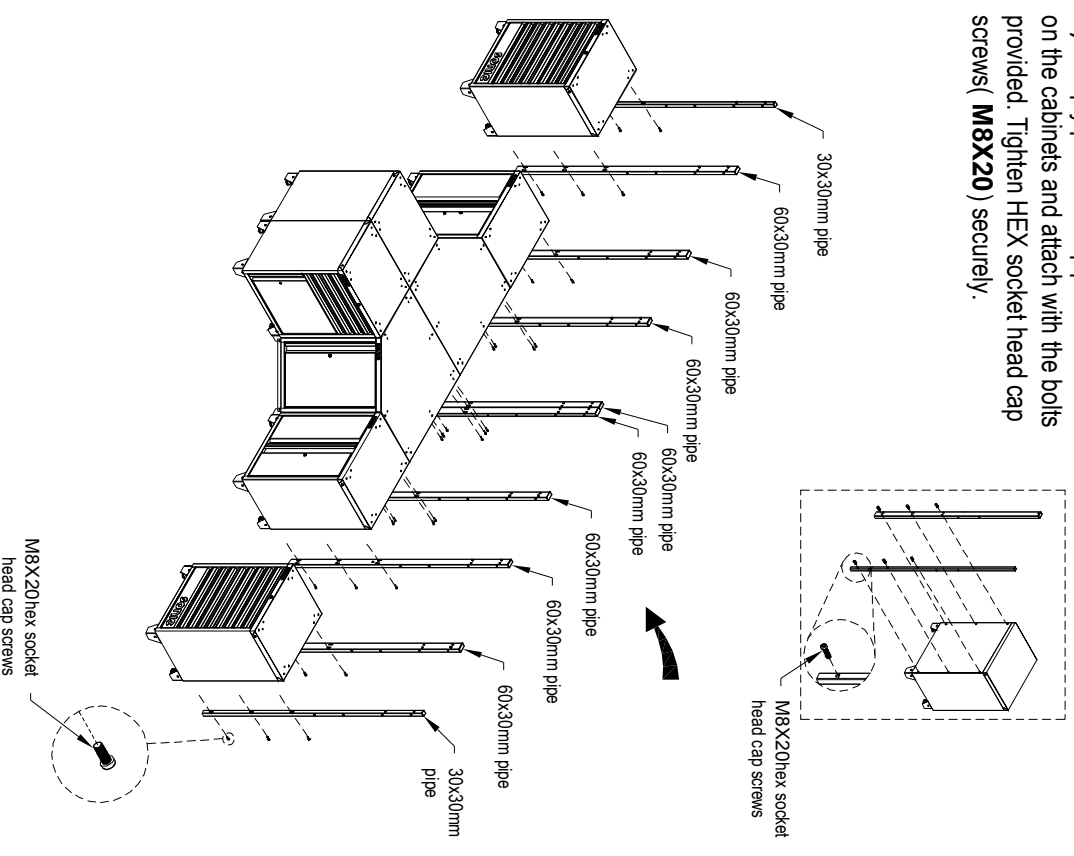

ASSEMBLY INSTRUCTIONS

2. INSTALL HANGER BOARD

Simply position the hanger board over the holes and attach with the bolts provided. Tighten philipps head bolt (**M6X12, stainless**) securely.

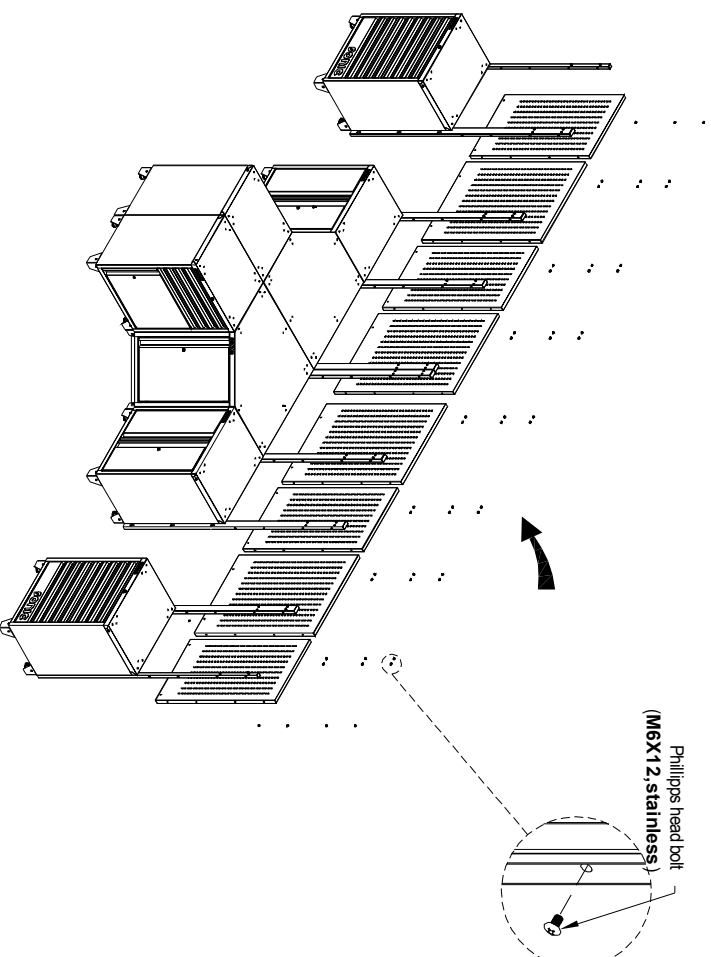

3. ADJUST THE LEVEL AND CONNECT EACH CABINET

A) Remove the drawers, shelves and doors.
Adjust the adjustable feet to make the whole set-up in a same level.

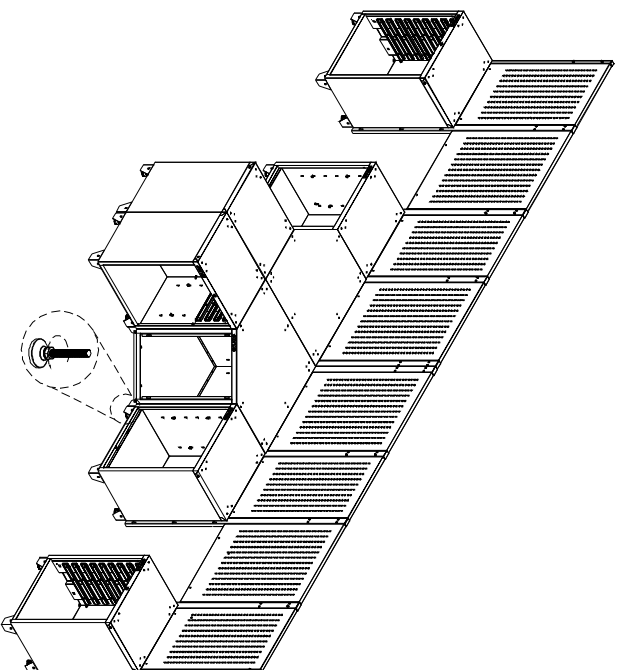

B) To connect each cabinet by hex flange bolt (M6x16) and hex flange nut. Tighten the screws securely.

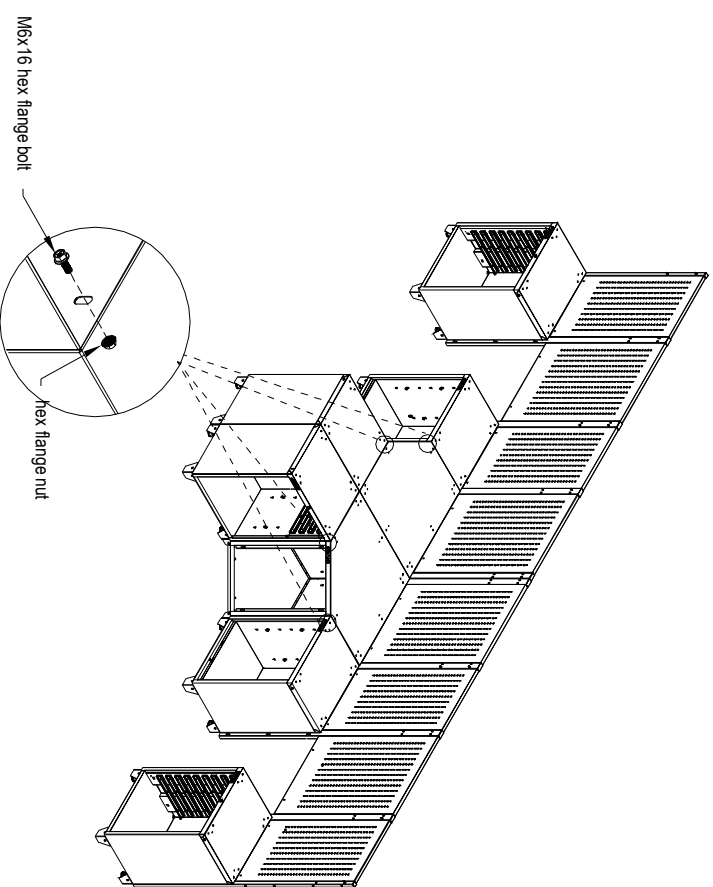

ASSEMBLY INSTRUCTIONS

4. INSTALL CUPBOARD

Hang the cupboards onto the screws and attach with the HEX socket head cap screws (**M6X16**) and washers provided. Do not tighten them yet. Make some space to hang up the wall chest. Open the chest and put 2 more screws (**M6X16**) and washers to connect with the post. Tighten the screws securely.

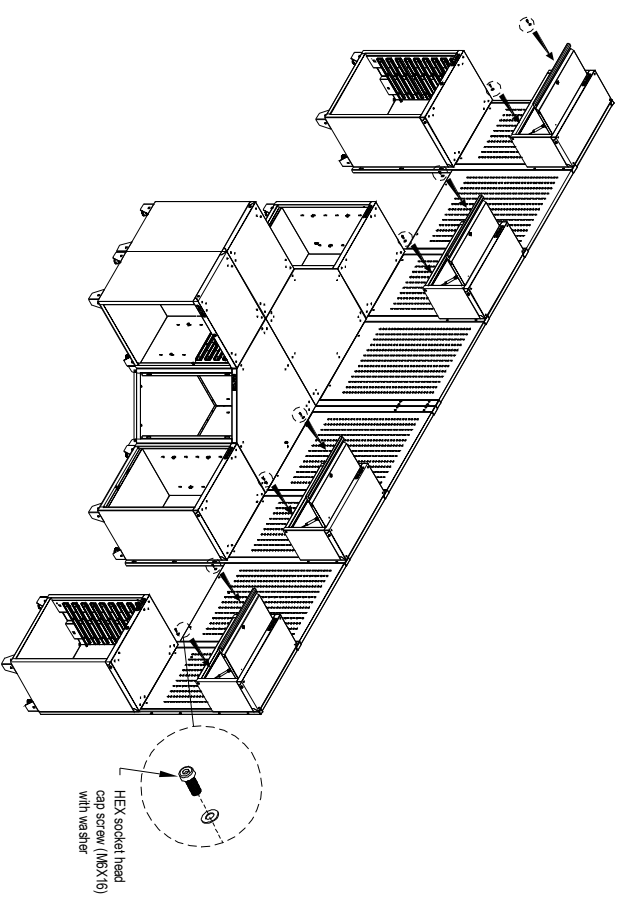
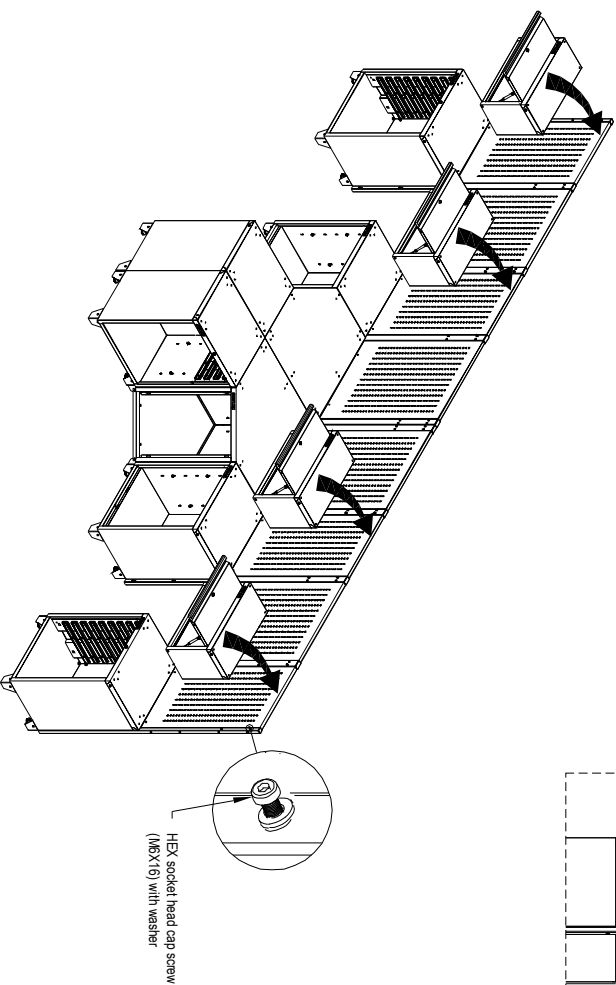
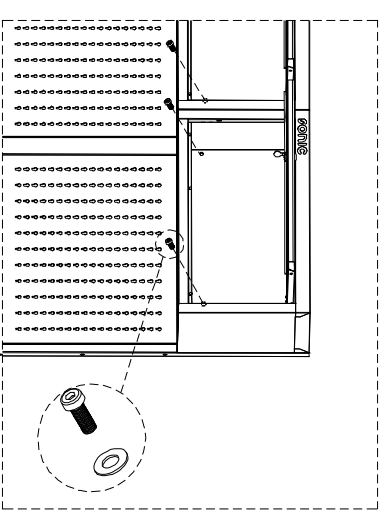
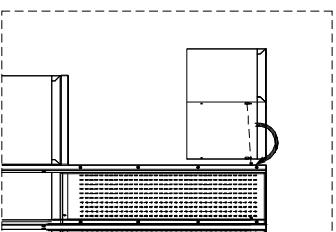

5. INSTALL THE WORK PLATES

A) Put the work plates on the cabinet.

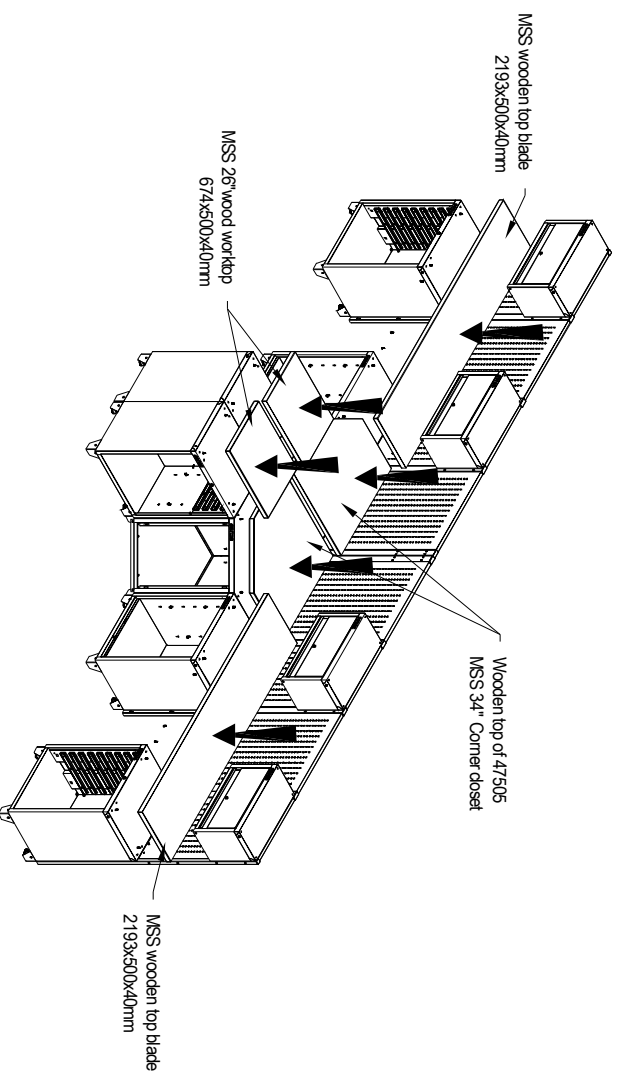

B) Position the work plates on the top of cabinets. Screw the hexagon bolt with flange screws (M4.8X25) through the top of cabinet by an electric screw driver into the bottom of the worktop. Tighten securely.
Reinstall the drawers, shelves and doors.

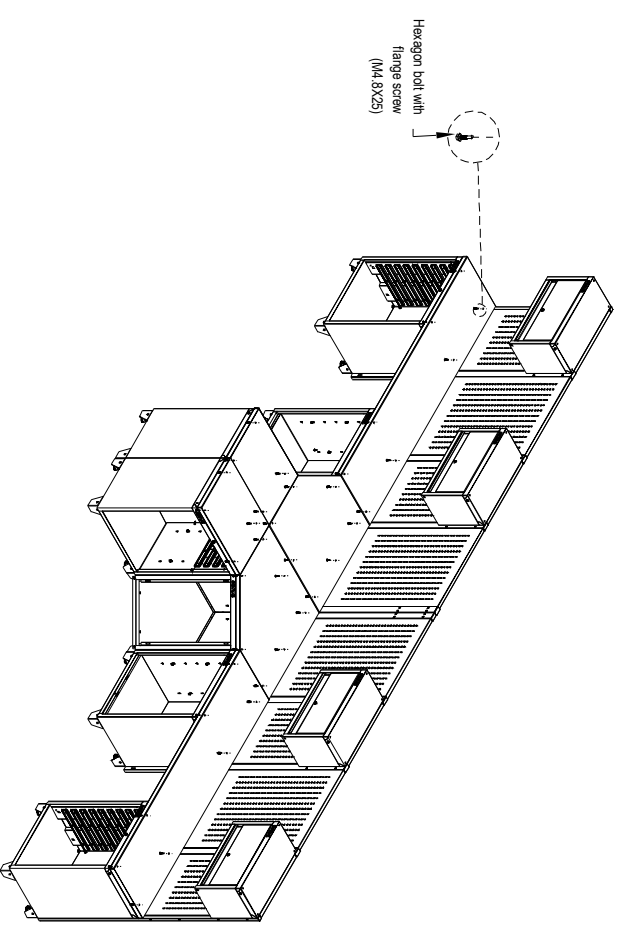

6. INSTALL SKIRTING BOARDS

Position the skirting boards on the legs of cabinets.
Insert the phillips head bolt (**M6X12,stainless**)
through the legs. Tighten securely. Repeat the steps
for other skirting boards.

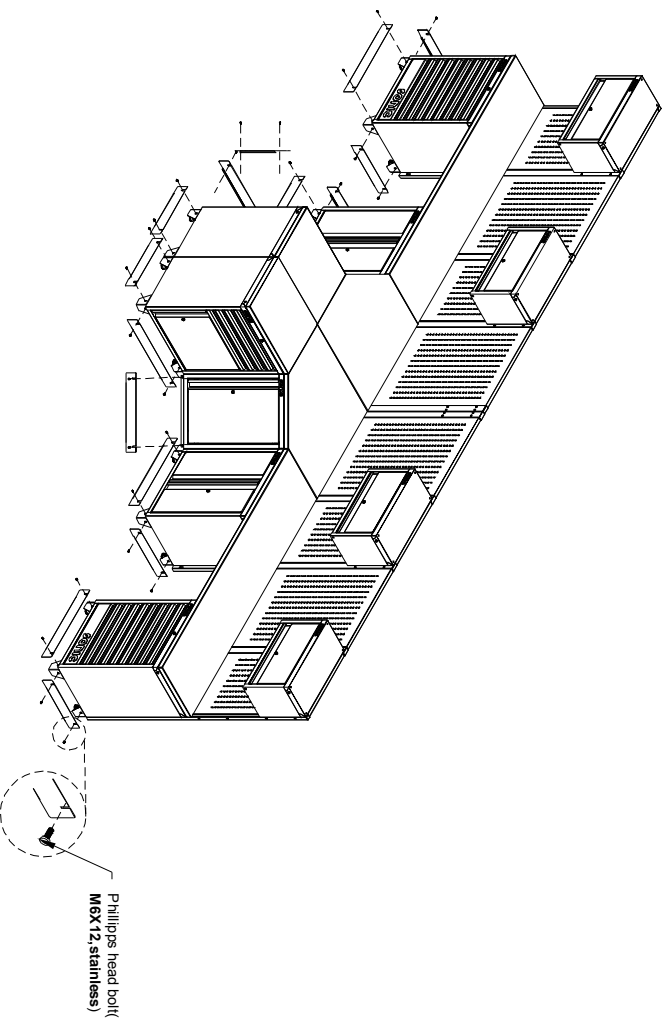

7. PUT IN TWO MSS 674MM TOOLBOX 7 DRAWERS.

