

Applications

Make	Model	Year
Citroen	Berlingo/Berlingo First I/II	2001-2011
	C2	2003-2010
	C3 I/II/First/Classic	2002-2010
	C3 Pluriel	2003-2010
	C4	2004-2011
	Nemo	2008-2010
	Saxo	2000-2003
	Xsara II	2000-2004
Peugeot	Bipper	2008-2010
	Partner/Partner Origin/Ranch I/II	2000-2011
	1007	2005-2010
	106	2000-2003
	206	2005-2009
	206+	2009-2013
	207	2006-2011
	306	2000-2002
	307	2001-2008

Engine Code

1.4	KFW (TU3A), KFW (TU3JP/L4), KFV (TU3A), KFV (TU3JP), KFU (ET3J4), TU3A (KFV) TU3A (KFW), TU3JP (KFW), ET3J4 (KFU), ET3JP4 (KFU), TU3JP (KFV)
-----	---

Our products are designed to be used correctly and with care for the purpose for which they are intended. No liability is accepted by Sonic for incorrect use of any of our products, and Sonic cannot be held responsible for any damage to personnel, property or equipment when using the tools. Incorrect use will also invalidate the warranty.

If applicable, the applications database and any instructional information provided has been designed to offer general guidance for a particular tool's use and while all attention is given to the accuracy of the data no project should be attempted without referring first to the manufacturer's technical documentation (workshop or instruction manual) or the use of a recognised authority such as Autodata.

It is our policy to continually improve our products and thus we reserve the right to alter specifications and components without prior notice. It is the responsibility of the user to ensure the suitability of the tools and information prior to their use.



Instructions

Engine Timing Kit
PSA Petrol - 1.4



829035 - Engine Timing Kit

Description:

The 829035 has been developed to offer the required engine locking tools to fit the popular PSA 1.4 belt driven 16v and 8v petrol engines. Fitted to the models listed between 2000 and 2013.

Components

Ref	Comp	OEM	Description
1	4880235	0132QY	Flywheel Timing Pin (Long)
2	4880112	4533-TAD/0132-AK	Timing Belt Clip
3	488	3mm Pin	Tensioner Pin
4	488090	0194-A	5mm Camshaft Locking Pin (Inlet 16V)
5	488096	4533-TAC1/0132-AJ1	8mm Camshaft Locking Pin (Exhaust 16V)
6	488054	0132RZ/4507-TB	10mm Camshaft Locking Pin (8V)
7	488053	4507-TA	Flywheel Timing Pin (Short)

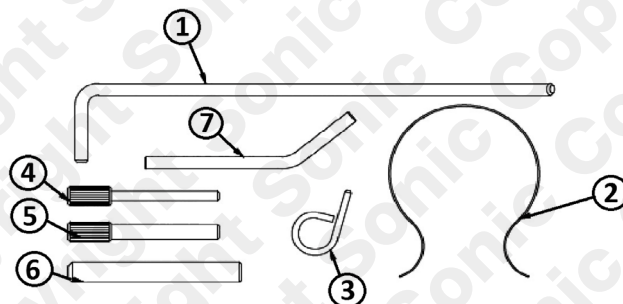

Instructions

The following instructions are for guidance only. Please refer to OEM derived data such as the vehicles manufactures own data or Autodata. The use of these engine timing tools is purely down to the user's discretion and Sonic cannot be held responsible for any damage caused what so ever.

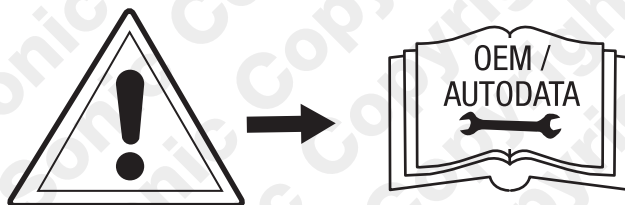

Instructions

1,4 8v ENGINES

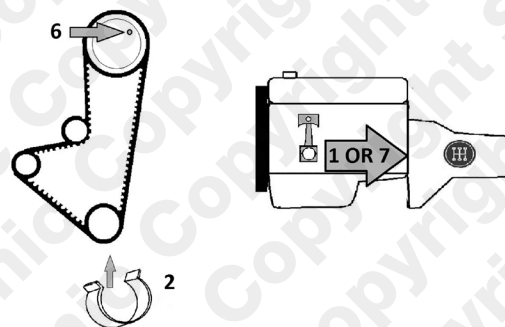

1,4 16v ENGINES

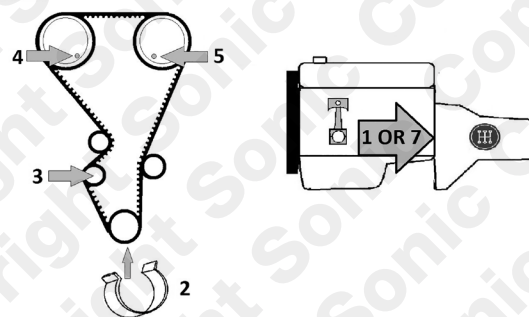

Component Descriptions:

Component 1 - Flywheel Timing Pin (Long)

Component 1 - flywheel locking pin - used to lock the flywheel in its timed position. It fits to the rear of the oil filter area and is used where access does not permit component 7 to be used.

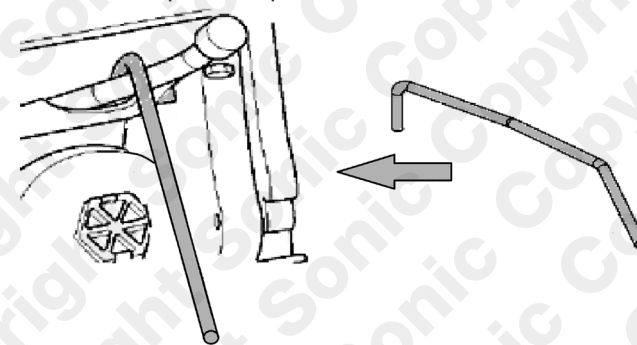

Component 2 - Cambelt Holding Clip

Component 2 is used to hold the new belt in place on the crankshaft while fitting the belt around the camshaft pulleys

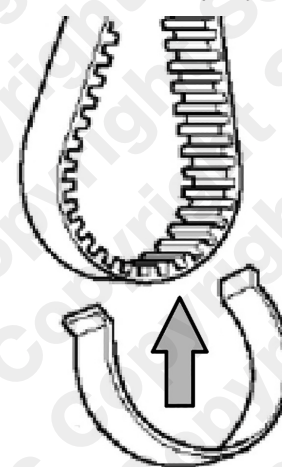

Component 3 - Tensioner Locking Pin

Used to lock the tensioner in its retracted position as shown.

