

Applications

Make	Model	Year	Types
Peugeot	Boxer	1999-2002	HDI TDI JTD
	Boxer II	2002-2006	
Fiat	Ducato	2002-2006	
Citroën	Relay/Jumper/II	2001-2006	

Engine Code

2.8	8140.63, 8140.43S, 8140.43, 8140.43N
-----	--------------------------------------

Our products are designed to be used correctly and with care for the purpose for which they are intended. No liability is accepted by Sonic for incorrect use of any of our products, and Sonic cannot be held responsible for any damage to personnel, property or equipment when using the tools. Incorrect use will also invalidate the warranty.

If applicable, the applications database and any instructional information provided has been designed to offer general guidance for a particular tool's use and while all attention is given to the accuracy of the data no project should be attempted without referring first to the manufacturer's technical documentation (workshop or instruction manual) or the use of a recognised authority such as Autodata.

It is our policy to continually improve our products and thus we reserve the right to alter specifications and components without prior notice. It is the responsibility of the user to ensure the suitability of the tools and information prior to their use.

ART NO. 829018

sonic
equipment

Instructions

Engine Timing Kit Fiat, PSA, Iveco JTD Diesel - 2.8



WWW.SONIC-EQUIPMENT.COM

WWW.SONIC-EQUIPMENT.COM

WWW.SONIC-EQUIPMENT.COM

829018 - Engine Timing Kit

Description:

The 829018 has been developed for Fiat 2.8 diesel engines that are found in the Fiat, Iveco and PSA van ranges. This kit provides all the tools required to set the timed components when replacing the timing belt. The kit also includes the components require to lock the flywheel when undoing and tightening up the front pulley fixings as well as the special spacer to hold the belt tensioner in its fully retracted position.

Components

Ref	Comp	OEM	Description
1	4880237	1 870 765 001	Flywheel Holding Tool
2	4880090	1 860 617 000	Camshaft/HP Pump Setting Pin 5.0mm (5 x 50)
3	4880097	8mm Pin	Flywheel Locking Pin (8mm Dia x 60)
4	4880132	1 860 638 000	Tensioning Tool

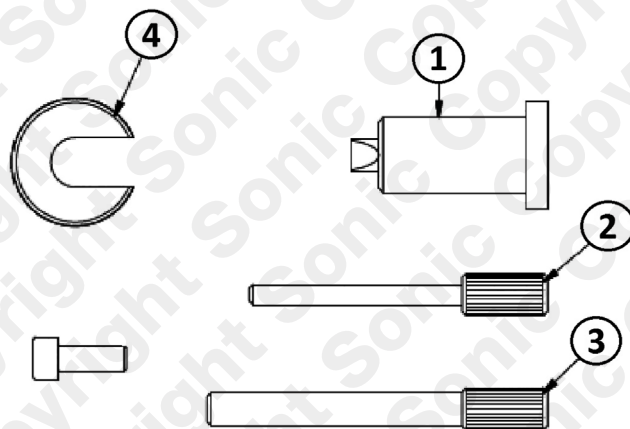

Instructions

The following instructions are for guidance only. Please refer to OEM derived data such as the vehicles manufactures own data or Autodata. The use of these engine timing tools is purely down to the user's discretion and Sonic cannot be held responsible for any damage caused what so ever.

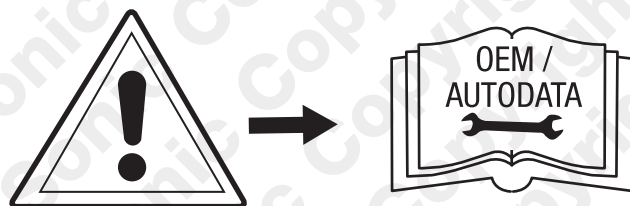

Instructions

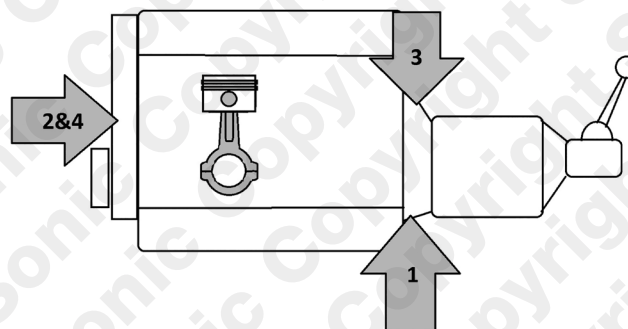

- Align all timing marks as described by OEM instructions.

Component 1 - Flywheel Holding Tool

Component 1 is used to lock and hold the flywheel to allow the front crankshaft pulley to be loosened or tightened.

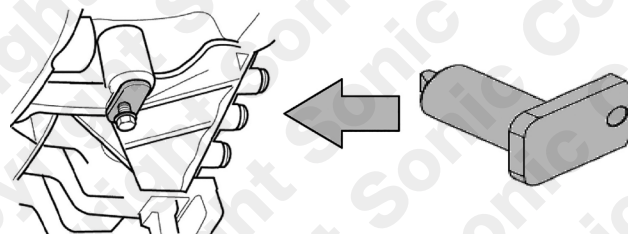

Component 2 - Camshaft/High Pressure Fuel Pump Locking Pin
Component 2 is used to lock the HP fuel pump pulley in its timed position NB – Never loosen or tighten the sprockets against these tools or damage will occur.

Component 3 - Flywheel Locking Pin (8mm Dia X 60)
Used to lock the Flywheel as shown.

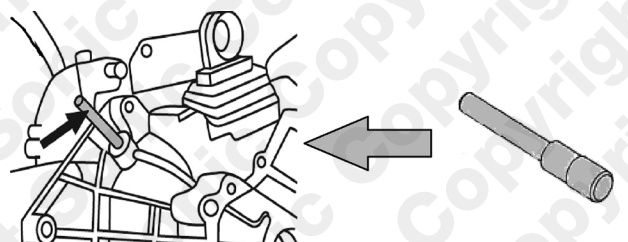

Component 4 - Tensioning Tool

Component 4 is to lock the cam belt tensioner in its fully retracted position.

