

Applications

Make	Model	Year	Type
Volkswagen	Lupo	1999-2005	
	Fox	2005-2011	
	Polo	1999-2014	
	Beetle	2000-2015	
	Caddy	2003-2010	
	Eos	2006-2010	
	Golf Plus	2005-2014	
	Golf IV	1998-2006	
	Golf IV Estate	1999-2006	
	Golf V	2003-2008	
	Golf V Estate	2007-2009	
	Golf VI	2008-2013	
	Golf VI Cabrio	2011-2015	
	Golf VI Estate	2009-2013	
	Jetta	2005-2015	
	Passat	1998-2015	
	Passat CC	2008-2012	
	Touran	2003-2015	
	Tiguan	2007-2011	
	Bora	1998-2005	
Audi	Sharan	1999-2010	TDI PD
	Transporter T5	2003-2010	TDI PD Ecomotive
	Eos	2008-2010	TDI PD GreenLine
	Scirocco	2008-2011	TDI PD BlueMotion
	A1/A1 Sportback	2010-2015	TDI PD FR
	A2	2000-2006	TDI PD vRS
	A3 Cabrio	2008-2013	TDIe PD
	A3/A3 Sportback	2001-2010	TDI CR
	A4 Cabrio	2005-2009	Ecomotive
	A4	1999-2012	Freerack
	A4 quattro	1999-2012	CR FR
	A4 allroad	2009-2012	GreenLine
	A5 Coupe	2009-2012	GreenLine II
	A5 Sportback	2009-2012	BlueMotion
	A5 Cabriolet	2008-2012	TDIe CR
	A6	1998-2011	SDI
	A6 quattro	2001-2005	vRS TDI PD
	Q5	2008-2010	Blue TDI CR
	TT	2008-2010	GTD CR
Skoda	Fabia/II	2000-2015	TDI CR FR/Sport
	Praktik	2007-2015	vRS TDI CR
	Roomster	2006-2015	
	Octavia II	2004-2013	
	Rapid	2012-2015	
	Rapid Spaceback	2013-2015	
	Octavia/Octavia Tour	2000-2010	
	Superb/II	2002-2015	
Seat	Yeti	2009-2010	
	Yeti Outdoor	2013-2015	
	Ibiza	2002-2015	
	Arosa	1999-2005	
	Cordoba	2002-2009	
	Altea/Altea XL	2004-2015	
	Leon	2000-2013	
	Toledo	2003-2015	
	Alhambra	1999-2010	
	Toledo	2000-2009	
	Exeo	2009-2012	

Engine Code	
1.2	ANY, AYZ
1.4	AMF, ATL, BAY, BHC, BMS, BNM, BNV, BWB
1.6	CAYB, CAYC, CAYA
1.9	AJM, ANU, ARL, ASZ, ATD, ATJ, AUY, AVB, AVF, AVQ, AWX, AXR, AXB, AXC, BJB, BKC, BKE, BLS, BLT, BMT, BPX, BRU, BRM, BRR, BRS, BRB, BSW, BSV, BSU, BTB, BUK, BVK, BXE, BXF
2.0	AZV, BKD, BDJ, BDK, BGW, BHW, BKP, BLB, BMM, BMN, BMP, BMA, BMR, BNA, BPW, BRC, BRT, BRE, BRF, BSS, BUY, BUZ, BVE, BVA, BVF, BVG, BWV
2.0 CR	CAGA, CAGC, CAGB, CAHA, CAHB, CBAB, CBAA, CBAC, CBBB, CBBA, CBDB, CBDC, CEGA

Our products are designed to be used correctly and with care for the purpose for which they are intended. No liability is accepted by Sonic for incorrect use of any of our products, and Sonic cannot be held responsible for any damage to personnel, property or equipment when using the tools. Incorrect use will also invalidate the warranty.

If applicable, the applications database and any instructional information provided has been designed to offer general guidance for a particular tool's use and while all attention is given to the accuracy of the data no project should be attempted without referring first to the manufacturer's technical documentation (workshop or instruction manual) or the use of a recognised authority such as Autodata.

It is our policy to continually improve our products and thus we reserve the right to alter specifications and components without prior notice. It is the responsibility of the user to ensure the suitability of the tools and information prior to their use.

ART NO. 829077

sonic
equipment

Instructions

Engine Timing Tool VAG Diesel PD Tdi - 1.2, 1.4, 1.9, 2.0



829077 - Engine Timing Tool

Description:
VAG Diesel Engine Timing Tool Master Kit offered specifically for the applications listed below. Designed to allow the replacement of the camshaft drive belts found on the popular VAG diesel engines from 1999 to 2015.

Components

Ref	Comp	OEM	Description
1	4880250	E10347 04	4.0mm Tensioner Pin
2	4880251	E10347 07	7.0mm Tensioner Pin
3	4880274	T10115	Locking Pin
4	4880092	T20102, 3359	Injection Pump/Cam Shaft Timing Pin
5	4880093	T10008	Tensioning Tool
6	4880140	T10050	Crankshaft Locking Tool
7	4880141	T10100	Crankshaft Locking Tool
8	4880157	T10060	Tensioner Pin
9	4880195	T40098	Tensioner Pulley Locking Pin [T40098]
10	4880196	T10265	Tensioner Pulley Locking Pin Ø2.5. [T10265]
11	4880197	T10264	6mm Ball End Hex Key
12	4880252	E10347 08	8.0mm Tensioner Pin
13	4880017	T10020 / V.159	Tensioner Lever
14	4880016	T10020 / 2287	Tensioner Lever

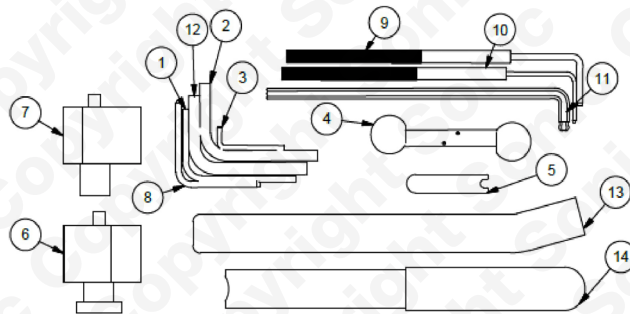

Instructions

The following instructions are for guidance only. Please refer to OEM derived data such as the vehicles manufactures own data or Autodata. The use of these engine timing tools is purely down to the user's discretion and Sonic cannot be held responsible for any damage caused what so ever.

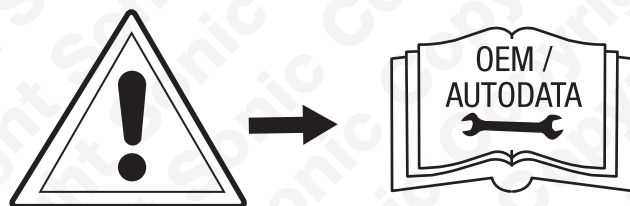

Instructions

Component 1, 2, 8, 12 - Tensioner pins.
1, 2 and 12 are used to lock belt and chain tensioners according to the size of the hole in the tensioner.

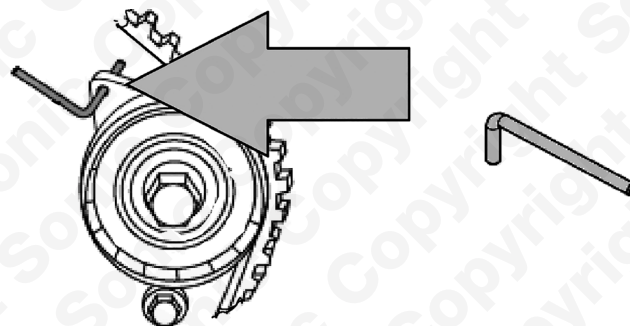

Component 4 - Injection Pump/Cam Shaft Timing Pin

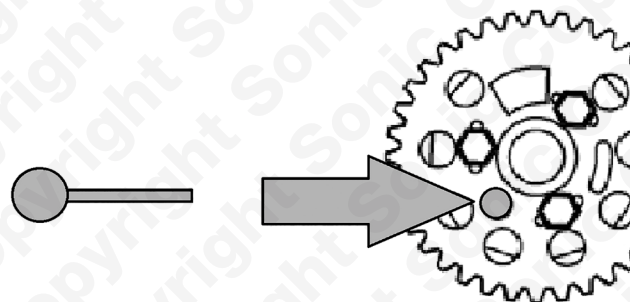

Component 5 - Tensioning Tool

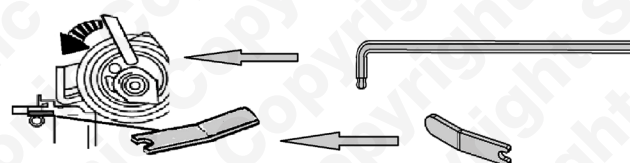

Component 6 & 7 - Crankshaft Locking Tool
Components 6 and 7 are crankshaft locking tools. Both tools are fitted by sliding from the front of the crankshaft pulley to slide into engagement with the teeth on the pulley. Only one tool will fit, to identify which tool is required check the position of the marks on the pulley as shown.

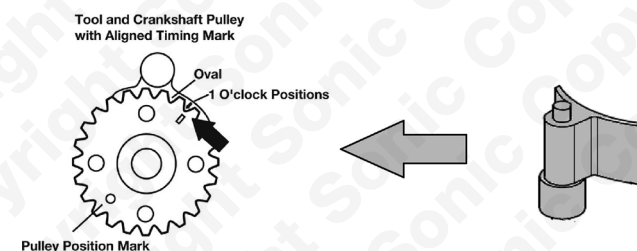
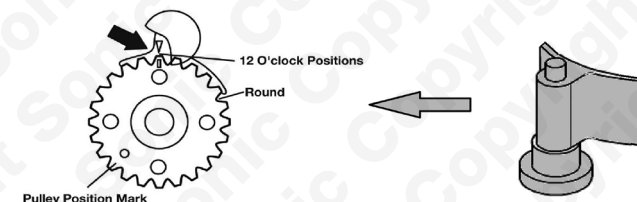

Component 13 & 14 - Tensioner Lever

