

Applications

Make	Model	Type	Year
Volvo	S40	DRIVE	2000-2012
	S80	Cross Country D2	2001-2015
	V50	D2	2004-2012
	V70	D5	2001-2015
	C30	D5 Polestar	2006-2013
	V40	D4	2000-2015
	C70	D3	2006-2013
	S60	D5 Polestar R-Design	2001-2015
	V60	D3/D4	2010-2015
	XC60	D3 DRIVE	2008-2015
	XC70	Turbo	2002-2016
	XC90		2002-2014

Engine Code

1.6	D4164T, D4162T
1.9	D4192T3, D4192T4
2.0	D5204T2, D5204T3, D5204T5, D5204T, D4204T, D4204T2
2.4	D5244T9, D5244T13, D5244T8, D5244T5, D5244T6, D5244T7, D5244T, D5244T2 D5244T3, D5244T4, D5244T10, D5244T11, D5244T15, D5244T14, D5244T19 D5244T17, D5244T16, D5244T18

Our products are designed to be used correctly and with care for the purpose for which they are intended. No liability is accepted by Sonic for incorrect use of any of our products, and Sonic cannot be held responsible for any damage to personnel, property or equipment when using the tools. Incorrect use will also invalidate the warranty.

If applicable, the applications database and any instructional information provided has been designed to offer general guidance for a particular tool's use and while all attention is given to the accuracy of the data no project should be attempted without referring first to the manufacturer's technical documentation (workshop or instruction manual) or the use of a recognised authority such as Autodata.

It is our policy to continually improve our products and thus we reserve the right to alter specifications and components without prior notice. It is the responsibility of the user to ensure the suitability of the tools and information prior to their use.

ART NO. 829079

sonic
equipment

Instructions

Engine Timing Kit Volvo Diesel 5 Cylinder - 2.0, 2.4



829079 - Engine Timing Kit

Description:

The 829079 kit provides all the essential engine timing tools to set and lock the engine components of the popular Volvo 2.0lt and 2.4lt 5 cylinder diesel engines to allow camshaft belt replacement.

- Additional recommended tooling – Sonic recommends the use of Sonic 829089 crankshaft pulley holding tool when tightening or loosening the crankshaft pulley fixing bolt.

Components

Ref	Comp	OEM	Description
1	4880272	999-7005	Volvo Crankshaft Timing Pin
2	4880271	999-7007	Volvo Camshaft Timing Pin
3	4880096	999-7122	Camshaft Locking Pin (8mm)
4	4880097	999-7169	Flywheel Locking Pin (8mm)
5	4880068	999-7121	Crankshaft Timing Pin
6	4880106	999-7120	Flywheel Lock tool
7	4880061	999-7119	Flywheel Locking Plate
8		999-7119	Tooth Block
9	4880332		Screw for above
10			Washer for above
11	4880197		6mm Ball End Hex Key
12	4880090	999-7233	Setting Pin 6.0mm

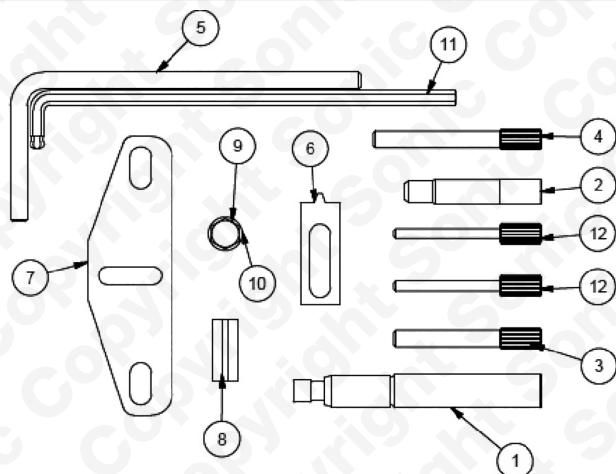

Instructions

The following instructions are for guidance only. Please refer to OEM derived data such as the vehicles manufactures own data or Autodata. The use of these engine timing tools is purely down to the user's discretion and Sonic cannot be held responsible for any damage caused what so ever.

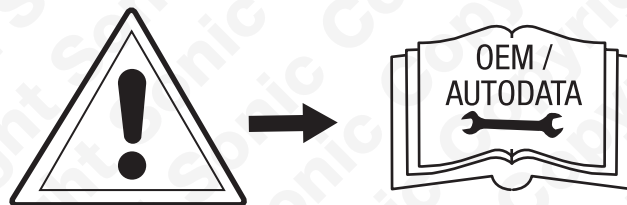

Instructions

Component 1 - Volvo Crankshaft Timing Pin.

Set the engine to just before TDC number 1 cylinder, fit component 1 and turn engine until the crankshaft web contact pin 1

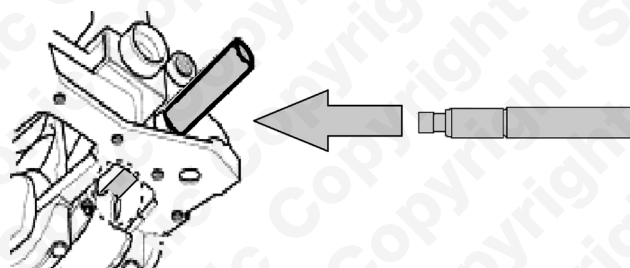

Component 2 - Volvo Camshaft Timing Pin

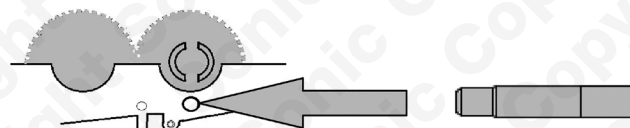

Component 3 - Camshaft Locking Pin (1.6 engines)

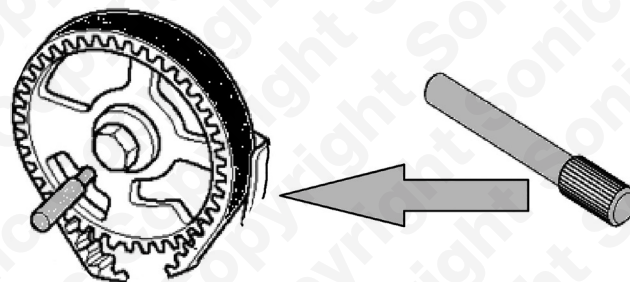

Component 4 - Flywheel Locking Pin (8mm) (1.6 engines)

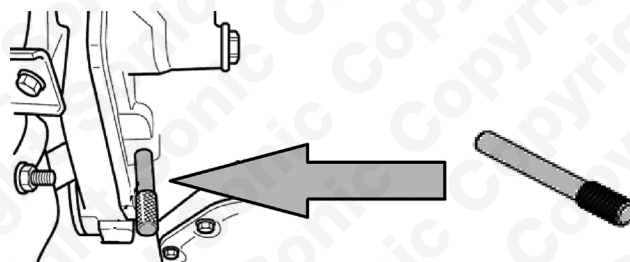

Component 5 - Crankshaft Timing Pin

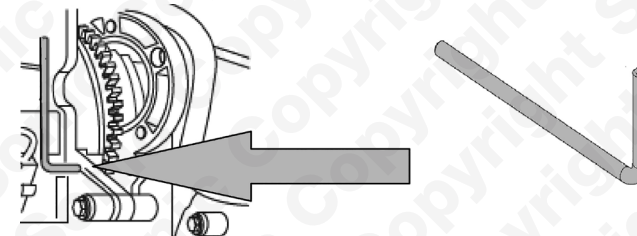

Component 6 - Flywheel Lock tool

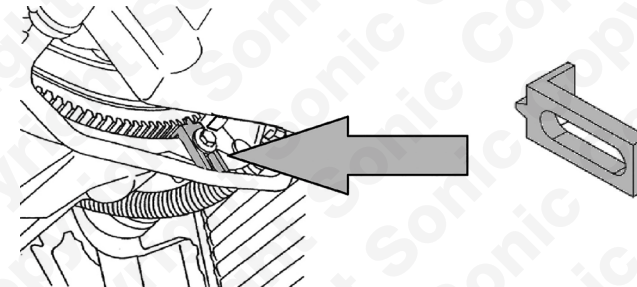

Component 7, 8, 9 & 10 - Flywheel Locking Tool

The use of 7, 8, 9 & 10 require the removal of the starter motor.

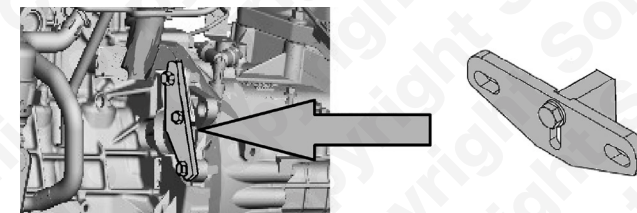

Component 12 - Crankshaft Timing Pin

Component 12 is used to lock the crankshaft on Volvo C30